

N series

RI61-RI62

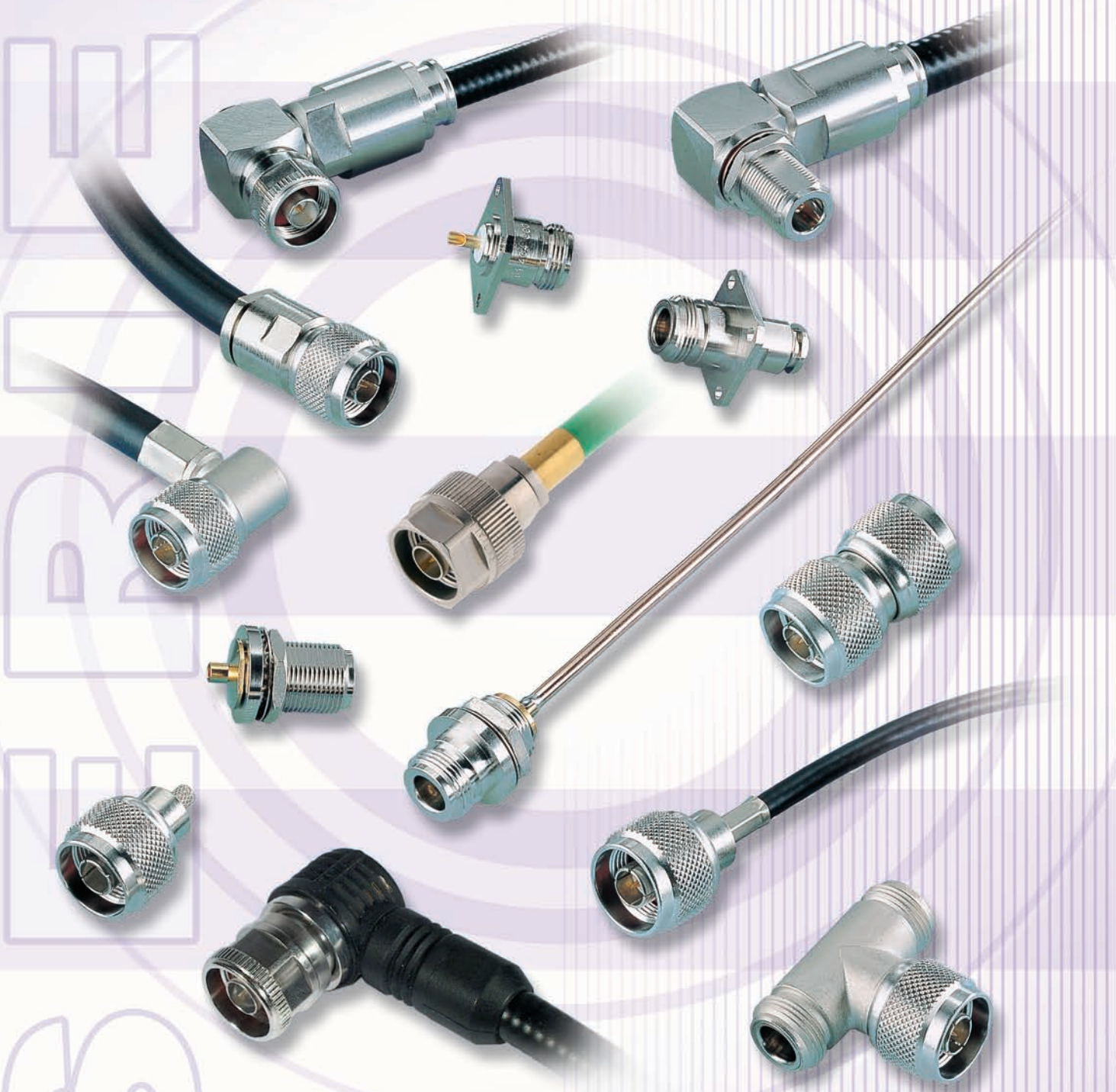

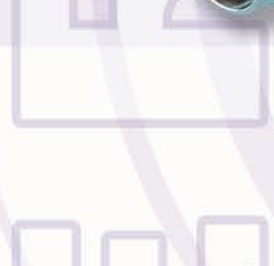
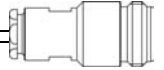

	PAGE
Introduction	4
General	5
Finder guide.....	6-8
N 50 Ω	
Interface.....	9
Characteristics	10-11
Straight plugs	12-13
Right angle plugs.....	14-15
Straight jacks	15-17
Flange mount, straight jacks.....	17-19
Bulkhead mount, straight jacks.....	19-21
Receptacles.....	22-24
In series adapters	25
Caps	26
Accessories	27
Cable assemblies	29-35
N 75 Ω	
Interface.....	36
Characteristics	37
Straight plugs	38
Right-angle plugs.....	39
Straight jacks	40
Flange mount, straight jacks.....	41
Bulkhead mount, straight jacks.....	41
Receptacles & adapters	42
Panel drilling	43
Assembly instructions.....	44-65

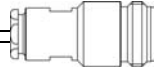

Radiall offers a wide range with a standard plating finish : **BBR (Bright Bronze Radiall)** = high performance non magnetic alloy.

• FULL CRIMP MODELS

A fast and reliable attachment system that can be easily achieved in a field environment, with minimum easy-to-use tooling (including models for 2 and 2.6 mm dia cables). All our full crimp connectors are single piece body.

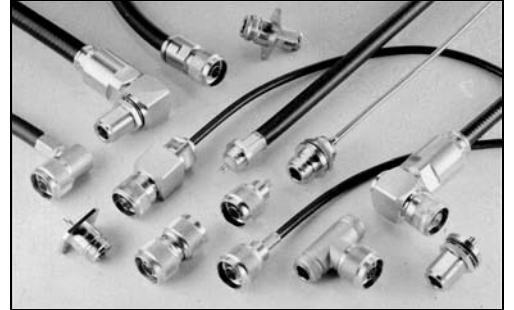

• LOW INTERMODULATION CONNECTORS

Radiall maintains extensive knowledge in this field and has developed N series connectors that are specially designed for base stations of applications where the elimination of intermodulation products is of the utmost importance :

- optimized for 900 - 1800 MHz bands (and able to work up to 11 GHz like the standard models),
- IMP_3 performance = -110 dBm (-153 dBc),
- new models for corrugated and low loss flexible cables,
- high performance non magnetic materials and platings (silver and BBR),
- new 6 flats coupling nut (18 mm), allowing high coupling torque (170 Ncm) thanks to torque wrench,
- non slotted outer contact.



• VERY LOW INTERMODULATION CABLE ASSEMBLIES

For severe intermodulation conditions, we propose a range of low intermodulation cable assemblies $IMP_3 \leq -125$ dBm.



• EZ FIT CONNECTORS

Radiall introduces its new EZ fit connectors. These two piece parts connectors are designed for a quick and easy installation in field conditions. Connectors are simply assembled by screwing the cable attachment and the body on the cable to create feeders or jumpers in only 3 steps without anticipation of the length of the cable assembly. With a very low intermodulation level, -112 dBm, these connectors feature as well a good moisture level, IP68.

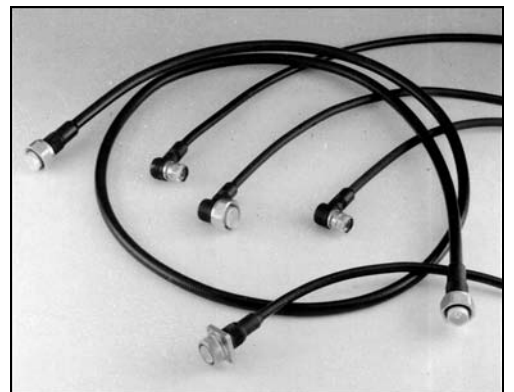

IMPORTANT: the 50 Ω and the 75 Ω connectors are **NOT INTERMATEABLE**, resulting in the interface destruction.

For further details, please read our: - Intermodulation application guide (**D1 032 DE**)
- BBR plating application guide (**D1 030 DE**)

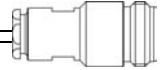

50 Ω	DC - 11 GHz
75 Ω	DC - 1.5 GHz

GENERAL

- Standard coaxial connectors
- Screw-on coupling
- High durability and proven strength
- High power rating
- Excellent RF performance
- 2 ranges : N 50 Ω
N 75 Ω

APPLICABLE STANDARDS

- MIL-C-39012 / MIL STD 348-304
- CEI 169-16
- CECC 22210
- NF-C-93566

APPLICATIONS

- Wireless communications
- Civil and military radio-telecommunication equipment
- Countermeasure
- Navy equipment
- Industrial applications

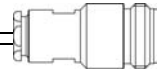

CABLE CONNECTORS R161 = 50 Ω / R162 = 75 Ω

Model cable	Straight plug			Intermod straight plug crimp or clamp/ EZ FIT	Right-angle plug			Intermod right- angle plug crimp or clamp/ EZ FIT	Straight jack		
	full crimp	clamp/EZ FIT	solder		crimp and full crimp	clamp	solder		full crimp	clamp	solder
2.6/50/S (RG 316)	R161 072 000 (page 12)	R161 004 000 (page 12)									
2.6/50/D (RD 316)	R161 072 000 (page 12)										
5/50/S (RG 58)	R161 082 000 (page 12)	R161 006 000 R161 010 000 (page 12)			R161 182 000 (page 14)	R161 157 000 (page 14)			R161 237 000 (page 15)	R161 206 000 (page 16)	
5/50/D (RG 142)	R161 083 000 (page 12)	R161 006 000 R161 010 000 (page 12)		R161 083 137 (page 12)	R161 183 000 (page 14)	R161 157 000 (page 14)		R161 183 137 (page 14)	R161 238 000 (page 15)	R161 206 000 (page 16)	
6/75/S (RG 59)	R162 084 000 (page 38)	R162 012 000 (page 38)			R162 184 000 (page 39)	R162 162 000 (page 39)			R162 239 000 (page 40)	R162 212 000 (page 40)	
8/75/D (RG 6)		R162 013 000 (page 38)								R162 213 000 (page 40)	
10/50/S (RG 213)	R161 075 000 (page 12)	R161 020 000 R161 022 000 (page 12)			R161 185 000 R161 184 000 (page 14)	R161 168 000 (page 14)			R161 241 000 (page 15)	R161 222 000 R161 220 000 (page 16)	
10/75/S (RG 11)	R162 075 000 (page 38)	R162 017 000 (page 38)			R162 185 000 (page 39)	R162 168 000 (page 39)			R162 241 000 (page 40)	R161 222 000 R162 217 000 (page 40)	
10.3/50/S (ETHERNET)	R161 076 000 (page 12)										
10.3/50/S (LMR400)	R161 075 060 (page 12)				R161 184 036 (page 14)						
11/50/D (RG 214)	R161 088 000 (page 12)	R161 020 000 R161 022 000 (page 12)		R161 088 137 (page 12)	R161 186 000 R161 187 000 (page 14)	R161 168 000 (page 14)		R161 186 137 (page 14)	R161 243 000 (page 15)	R161 222 000 R161 220 000 (page 16)	
11/75/D (RG 216)	R162 088 000 (page 38)	R162 017 000 (page 38)			R162 187 000 (page 39)	R162 168 000 (page 39)			R162 243 000 (page 40)	R161 222 000 R162 217 000 (page 40)	
.141" (RG 402)		R161 052 000 (page 13)	R161 051 000 (page 13)					R161 152 107 (page 15)		R161 227 080 (page 17)	R161 226 020 (page 17)
.250" (RG 401)		R161 053 000 (page 13)	R161 054 000 (page 13)								
1/4" super- flexible corrugated				R161 036 007 (page 13)				R161 177 007 (page 15)		R161 232 007 (page 16)	
3/8" super- flexible corrugated				R161 036 207 (page 13)				R161 177 207 (page 15)		R161 232 207 (page 16)	
1/2" flexible corrugated		R161 091 020W (page 13)								R161 230 320W (page 16)	
1/2" super- flexible corrugated				R161 037 020 (page 13)				R161 177 137 (page 15)		R161 232 407 (page 16)	
7/8" flexible corrugated		R161 033 020W (page 13)								R161 231 020W (page 16)	

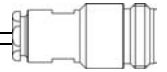

CABLE CONNECTORS R161 = 50 Ω / R162 = 75 Ω

Model cable	Intermod straight jack clamp/EZ FIT	Square flange straight jack			Intermod square flange straight jack clamp/EZ FIT	Bulkhead straight jack (panel sealed)			Intermod bulkhead straight jack clamp/EZ FIT
		full crimp	clamp	solder		full crimp	clamp	solder	
2.6/50/S (RG 316)			R161 252 000 (page 18)			R161 311 x00 (page 19)	R161 321 000 R161 322 000 (page 20)		
2.6/50/D (RG 316)			R161 252 000 (page 18)			R161 311 x00 (page 19)	R161 321 000 R161 322 000 (page 20)		
5/50/S (RG 58)			R161 256 000 (page 18)			R161 329 000 (page 19)	R161 325 000 (page 20)		
5/50/D (RG 142)		R161 283 000 (page 17)	R161 256 000 (page 18)			R161 329 200 (page 19)	R161 325 000 (page 20)		
6/75/S (RG 59)			R162 262 000 (page 41)			R162 335 000 (page 41)	R162 328 000 (page 41)		
10/50/S (RG 213)		R161 286 000 (page 17)	R161 270 000 (page 18)				R161 332 000 (page 20)		
10/75/S (RG 11)			R162 267 000 (page 41)			R162 336 000 (page 41)	R162 332 000 (page 41)		
11/50/D (RG 214)		R161 286 200 (page 17)	R161 270 000 (page 18)				R161 332 000 (page 20)		
11/75/D (RG 216)			R162 267 000 (page 41)			R162 339 000 (page 41)	R162 332 000 (page 41)		
.085" (RG 405)								R161 335 200 (page 21)	
.141" (RG 402)			R161 277 000 (page 19)	R161 277 300 (page 19)			R161 323 0x0 (page 21)	R161 332 200 R161 323 200 R161 336 000 (page 21)	
.250" (RG 401)			R161 278 000 (page 19)					R161 337 200 (page 21)	
1/4" super- flexible corrugated	R161 232 007 (page 16)				R161 279 007 (page 18)				R161 341 007 (page 20)
3/8" super- flexible corrugated	R161 232 207 (page 16)				R161 279 207 (page 18)				R161 341 207 (page 20)
1/2" super- flexible corrugated	R161 232 407 (page 16)				R161 279 407 (page 18)				R161 341 407 (page 20)

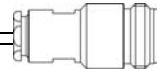
PANEL RECEPTACLES R161 = 50 Ω / R162 = 75 Ω

Model	Straight female flange			Right-angle female flange 25.4 mm square	Straight male flange 25.4 mm square	Straight female bulkhead (panel sealed or hermetical)	
	12.7 mm square	17.5 mm square 2 holes	25.4 mm square			front mount	rear mount
Contact with solder pot		R161 410 000 (page 22)	R161 404 xxx R161 412 020 R161 430 020 (page 23) R162 403 000 (page 42)	R161 653 000 (page 24)	R161 440 020 R161 441 000 (page 23)	R161 570 000 R161 625 000 (page 24) R162 570 000 (page 42)	R161 606 000 (page 24)
Extended dielectric contact	R161 410 520 (page 22)		R161 416 130 (page 23)		R161 441 400 (page 23)		
Flat tab contact		R161 461 000 (page 22)	R161 419 020 (page 23)				
Slotted contact			R161 419 300 (page 23)		R161 444 037 (page 23)		
Removable contact (universal receptacle)		R161 418 000 (page 22)					

IN-SERIES ADAPTERS R161 = 50 Ω / R162 = 75 Ω

Model	Straight	Straight flange	Straight bulkhead	Straight slide-on	Right-angle	Tee
M - M	R161 703 000 (page 25) R162 703 000 (page 42)					
F - F	R161 705 000 (page 25) R162 705 000 (page 42)	R161 715 000 (page 25)	R161 730 000 R161 753 000 (page 25)			
M - F				R161 791 5x0 (page 25)	R161 771 000 (page 25)	
F - F / M						R161 780 000 (page 25)
F - F / F						R161 782 000 (page 25)

CAPS

Model	Cord	Chain	Chain short-circuit
M	R161 804 000 R161 805 410 (page 26)	R161 853 000 (page 26)	R161 862 000 (page 26)
F	R161 844 000 (page 26)	R161 841 000 (page 26)	

ATTENTION ! This guide is intended as an information and does not include all N SERIES P/N

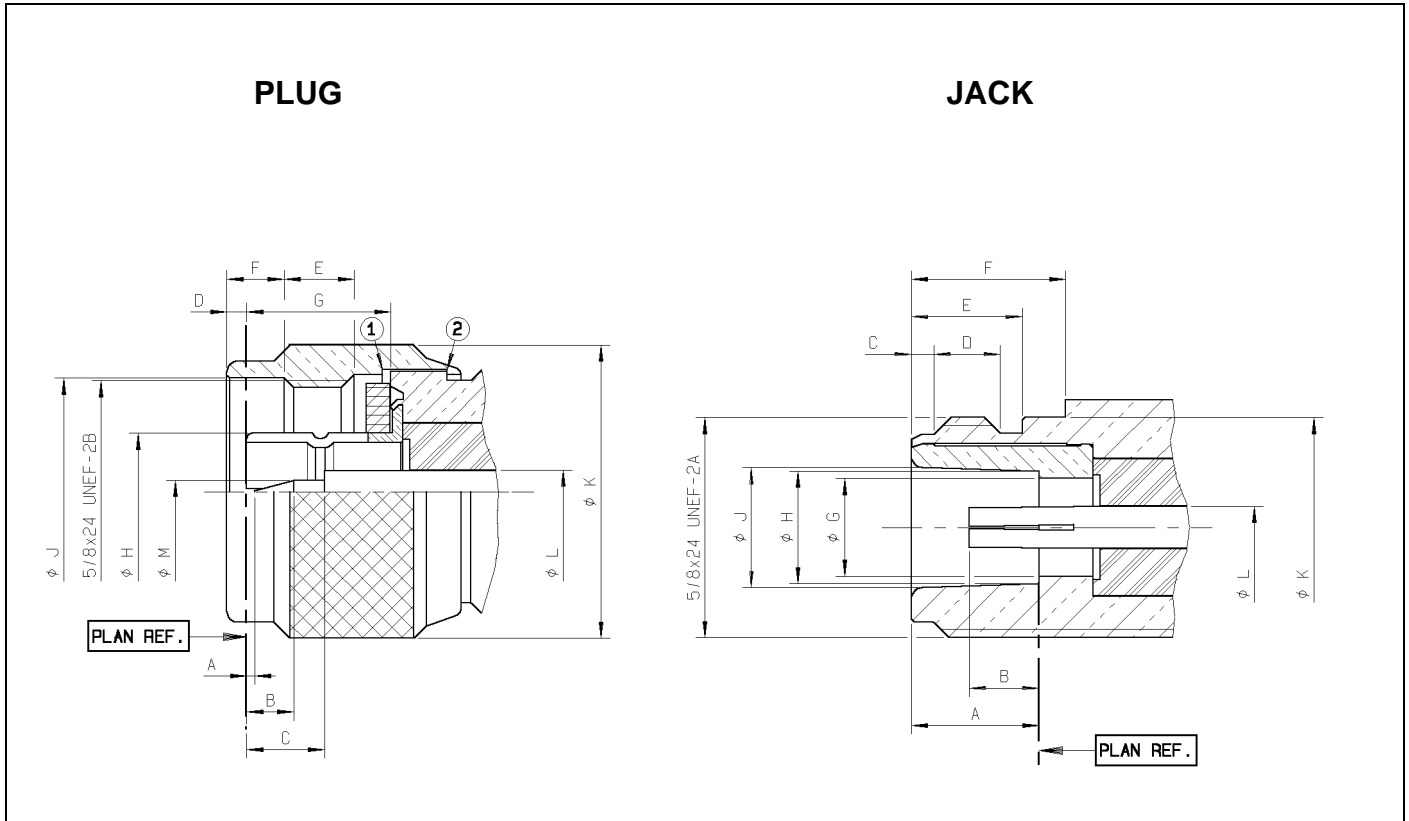
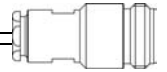

LETTER	mm		inch	
	min.	max.	min.	max.
A	0.13	1.03	.005	.13
B	2.80	3.56	.110	.140
C	5.33	5.83	.210	.229
D	1	2	.016	.066
E	4.54	5.39	.179	.212
F	4.05	4.20	.159	.165
G	10.23	10.43	.403	.411
H DIA	8.27	8.37	.326	.329
J DIA	16.1	16.2	.634	.638
K DIA	20.9	21	.823	.827
L DIA	3.01	3.05	.118	.120
M DIA	1.63	1.67	.064	.066

LETTER	mm		inch	
	min.	max.	min.	max.
A	9.05	9.19	.356	.362
B	4.75	5.25	.187	.207
C	1.20	1.95	.047	.077
D	4.4	5.1	.173	.201
E	6.8	9	.268	.354
F	10.9	11.2	.429	.441
G DIA	6.98	7.02	.275	.276
H DIA	8.03	8.13	.316	.320
J DIA	8.53	8.73	.336	.344
K DIA	15.65	15.85	.616	.624
L DIA	3.01	3.05	.118	.120

IMPORTANT: the 50 Ω and the 75 Ω connectors are **NOT INTERMATEABLE**, resulting in the interface destruction

All dimensions are given in mm (inch)



TEST/CHARACTERISTICS	STANDARD REFERENCE	VALUES/REMARKS
----------------------	--------------------	----------------

ELECTRICAL CHARACTERISTICS

Impedance		50 Ω			
Frequency range		DC - 11 GHz			
V.S.W.R. (typ.)	Frequency	1 GHz 2.5 GHz 5 GHz 11 GHz			
• <i>Straight models cable group</i>	.085"	1.03	1.03	1.05	1.08
	.141"	1.03	1.05	1.05	1.08
	.250"	1.03	1.03	1.05	1.07
	5 S + 5 D	1.05	1.06	1.1	1.16
	10 S + 11 D	1.04	1.05	1.09	1.2
• <i>Right angle models</i>	5 S + D	1.04	1.05	1.18	
	10 S + 11 D	1.04	1.1	1.20	
Intermodulation product (IMP ₃)		- 90 dBm typ. (- 133 dBc typ. / 20W) - 110 dBm typ. (- 153 dBc typ. / 20 W) - 125 dBm typ. (- 165 dBc typ. / 20W)			
• <i>Standard connectors</i> • <i>Intermodulation connectors</i> • <i>Home made intermodulation cable assemblies</i>					
Insertion loss	straight connector right-angle connector	MIL	< 0.15 dB max at 10 GHz ~ < 0.05 √F (GHz) < 0.15 dB max at 10 GHz ~ < 0.1 √F (GHz)		
RF Leakage		MIL	- 90 dB min from 2 to 3 GHz (interface)		
Insulation resistance		MIL	5000 MΩ min		
Contact resistance	center contact outer contact	MIL	Initial 1 mΩ 0.2 mΩ	After tests 1.5 mΩ -	
Working voltage in VRMS	at sea level (at 70, 000 feet)	CECC	Cable 5 / 50: 850 (250) Cable .085" / .141": 350 (250) Cable 10+11/50: 1400 (400) Cable LMR 400/600: 1400 (400) Cable .250": 1400 (400)		
Dielectric withstanding voltage in VRMS	at sea level (at 70, 000 feet)	CECC	Cable 5 / 50: 1500 (350) Cable .085" / .141": 1000 (350) Cable 10/50: 2500 (600) Cable LMR400/600: 2500 (600) Cable .250": 2500 (600)		
RF testing voltage	sea level	CECC	1500 VRMS (5 MHz sine wave)		

MECHANICAL CHARACTERISTICS

Durability		CECC	500 matings
Force to engage and disengage		CECC	6.6 Ncm max (.58 Inch-pounds)
Recommended coupling nut torque			40 to 60 Ncm (manual) 130 Ncm (11.45 inch pounds) (with pliers R 282 202 000) 170 Ncm (14.96 inch pounds) (with torque wrench R 282 303 020)
Proof torque		CECC	170 Ncm (14.96 inch pounds)
Coupling nut retention force		CECC	450 N (101.25 Lbs)
Cable retention force		CECC	Cable 5/50/S: 150 N (33.75 Lbs) Cable 5/50/D: 200 N (48 Lbs) Cable 10/50: 300 N (67.5 Lbs) Cable 11/50: 400 N (90 Lbs) Cable .141": 270 N (60.75 Lbs)
Center contact retention force	axial	MIL	27 N (6.08 Lbs) cables < Ø 8 mm 68 N (15.30 Lbs) cables > Ø 8 mm

Standard packaging = 50 pieces. For unit packaging add «W» after the P/N

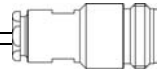

TEST/CHARACTERISTICS	STANDARD REFERENCE	VALUES/REMARKS
----------------------	--------------------	----------------

ENVIRONMENTAL CHARACTERISTICS

TEST/CHARACTERISTICS	STANDARD REFERENCE	VALUES/REMARKS
Temperature range standard models semi-rigid cables	CECC	- 55°C + 155°C - 55°C + 105°C
Thermo cycling test	CECC	- 55°C / + 155°C / 21 j
Thermal shock	CECC	- 40°C / + 155°C or - 40°C / + 85°C – 5 cycles
Hight temperature test	CECC	125°C / 1000 H
Corrosion salt spray	CECC	48 H

ENVIRONMENTAL CHARACTERISTICS

TEST/CHARACTERISTICS	STANDARD REFERENCE	VALUES/REMARKS
Vibration	CECC	Sinus 10 g / 10 – 500 Hz
Shock	CECC	1/2 Sinus 50g / 11 ms
Moisture resistance clamp type crimp type	IEC 529	IP 67 IP 65 (with heatshrink sleeve)
Hermetic test	CECC	10-5 bar. cm ³ /s
Leakage	CECC	Differential pressure 100 to 110 KPa: 1 bar cm ³ / H

MATERIALS

Body / nut / center male contact / outer contact		Brass
Center female contact		Treated beryllium copper
Ferrule		Brass
Insulator		PTFE
Gasket		Silicon elastomer

PLATINGS

TEST/CHARACTERISTICS	STANDARD REFERENCE	VALUES/REMARKS
Body crimp + clamp type solder type	Standard	Intermodulation models + COAXI-KIT
Coupling nut / Design	BBR* / cross knurled	Silver + BBR* Silver
Center contacts	Gold	BBR* / hex.
Outer contacts / Design	BBR* / slotted	Silver
		Silver + BBR* / non slotted

POWER RANGE

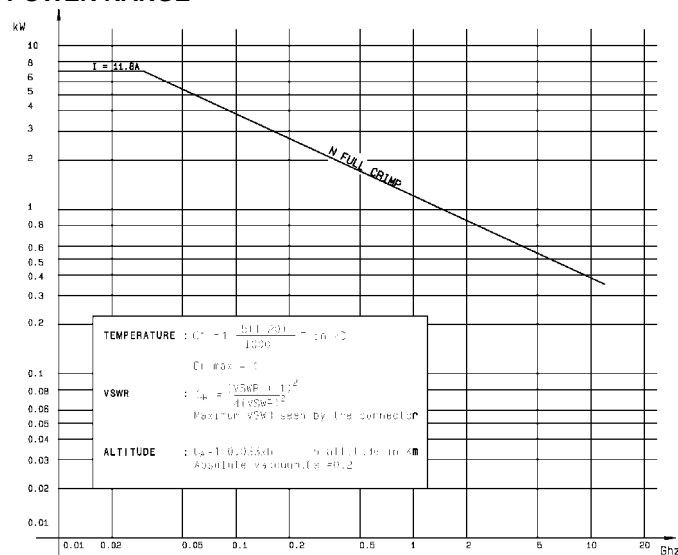

Some connectors may feature different performances depending on the application they have been designed for, or according to the applicable cable.

* BBR : Bright Bronze Radial



STRAIGHT PLUGS, FULL CRIMP TYPE, FOR FLEXIBLE CABLES (single piece body)

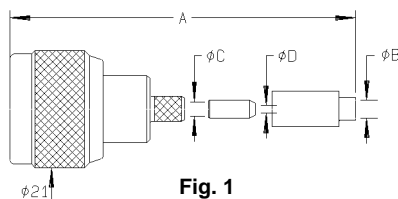

Fig. 1

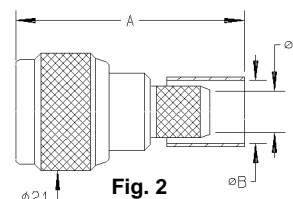

Fig. 2

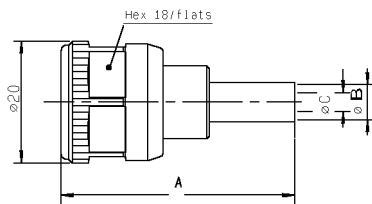

Fig. 3

Cable group	Part number	Fig.	Dimensions (mm)				Captured center contact	Assembly instructions	Note
			A	B	C	D			
2.6 / 50 / S+D	R161 072 000	1	39.7	3.25	3.38	1.63	yes	M09	
5 / 50 / S	R161 082 000	2	38.5	5.41	3.11		yes	M12	
5 / 50 / D	R161 083 000	2	38.5	5.8	3.11		yes	M12	
5 / 50 / D	R161 083 137	3	38.5	5.8	3.11		yes	M11	For intermodulation application / tool
10 / 50 / S	R161 075 000	2	40.2	11.05	7.46		yes	M10	
10.3 / 50 / S	R161 075 060	2	40.2	11.05	7.46		yes	M10	LMR 400 cable
10.3 / 50 / D	R161 076 000	2	40.2	11.4	6.4		yes	M10	ETHERNET cable
11 / 50 / D	R161 088 000	2	40.2	11.4	7.46		yes	M10	
11 / 50 / D	R161 088 137	3						M11	For intermodulation application / tool

STRAIGHT PLUGS, CLAMP TYPE, FOR FLEXIBLE CABLES

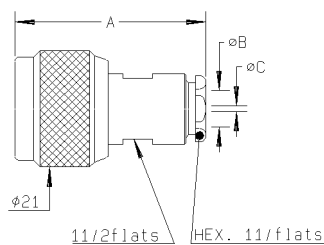

Fig. 1

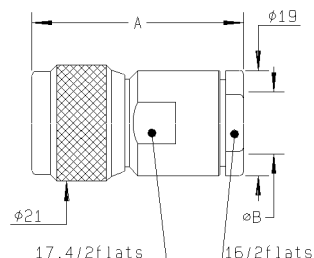
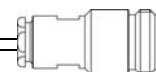

Fig. 2

Cable group	Part number	Fig.	Dimensions (mm)			Captured center contact	Assembly instructions
			A	B	C		
2.6 / 50 / S + D	R161 004 000	1	33.9	3.1	1.7	yes	M01
5 / 50 / S + D	R161 006 000	1	34.4	5.6		no	M02
5 / 50 / S + D	R161 010 000	1	34.9	5.6		yes	M03
10 + 11 / 50 / S + D	R161 020 000	2	38.1	11.2		no	M04
10 + 11 / 50 / S + D	R161 022 000	2	38.9	11.2		yes	M05



STRAIGHT PLUGS, EZ FIT TYPE, FOR CORRUGATED CABLES

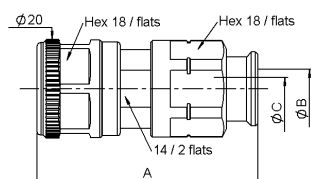

Fig. 1

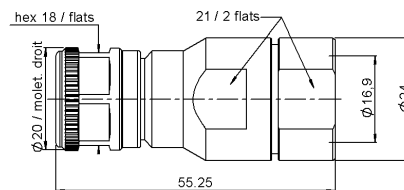

Fig. 2

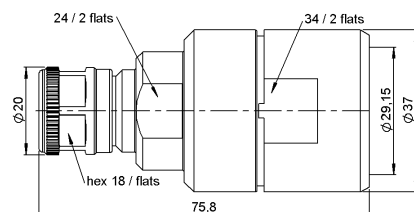

Fig. 3

Cable group	Part number	Fig.	Dimensions (mm)			Captured center contact	Assembly instructions
			A	B	C		
1/4" superflexible corrugated	R161 036 007	1	44.7	7.95	4.7	yes	M18
3/8" superflexible corrugated	R161 036 207	1	45.1	11	7.1	yes	M18
1/2" flexible corrugated	R161 091 020W	2				yes	M19
1/2" superflexible corrugated	R161 037 020	1	45.1	14	8.8	yes	M18
7/8" flexible corrugated	R161 033 020W	3				yes	M20

STRAIGHT PLUGS, FOR SEMI-RIGID CABLES

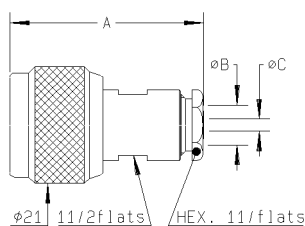
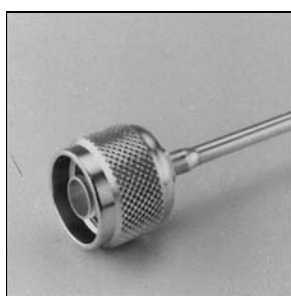

Fig. 1

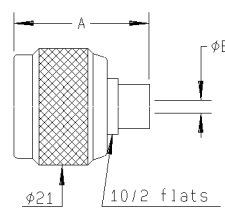

Fig. 2

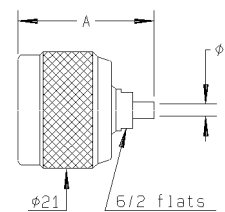
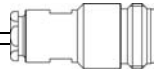
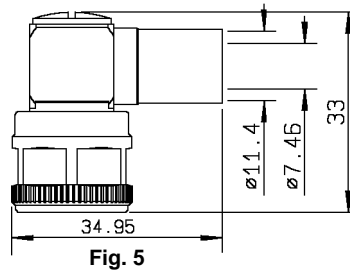
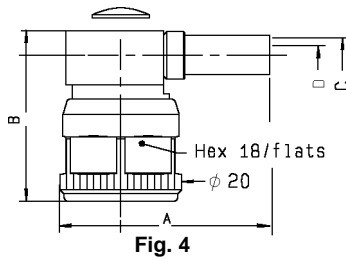
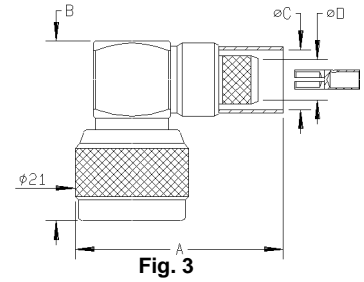
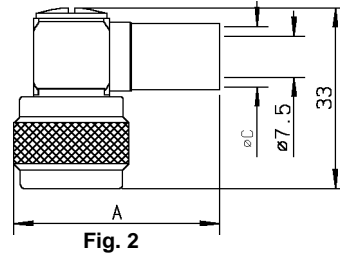
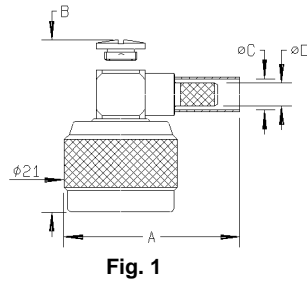

Fig. 3

Cable group	Part number	Fig.	Dimensions (mm)			Captured center contact	Assembly instructions	Note
			A	B	C			
.141"	R161 051 000	3	24.4	3.65		no	M07	Solder type
.141"	R161 052 000	1	35	5.6	3.65	no	M06	Clamp type
.250"	R161 053 000	1	35.4	6.6		no	M06	Clamp type
.250"	R161 054 000	2	24.4	6.45		no	M07	Solder type



RIGHT ANGLE PLUGS, CRIMP TYPE, FOR FLEXIBLE CABLES



Cable group	Part number	Fig.	Dimensions (mm)				Captured center contact	Assembly instructions	Note
			A	B	C	D			
5 / 50 / S	R161 182 000	1	34.5	28	5.41	3.1	yes	M08	
5 / 50 / D	R161 183 000	1	34.5	28	5.8	3.1	yes	M08	
5 / 50 / D	R161 183 137	4	35	28.3	5.8	3.1	yes	M08	For intermodulation application / tool
10 / 50 / S	R161 184 000	2	37.5		11.05		yes	M08	
10 / 50 / S	R161 185 000	3	42.4	33.2	11.05	7.46	yes	M11	Full crimp
10.3 / 50 / S	R161 184 036	2	46.25		11.05		yes	M08	LMR 400 cable
11 / 50 / D	R161 186 000	2	37.6		11.4		yes	M08	
11 / 50 / D	R161 187 000	3	42.4	33.2	11.4	7.46	yes	M11	Full crimp
11 / 50 / D	R161 186 137	5					yes	M08	For intermodulation application / tool

RIGHT ANGLE PLUGS, CLAMP TYPE, FOR FLEXIBLE CABLES

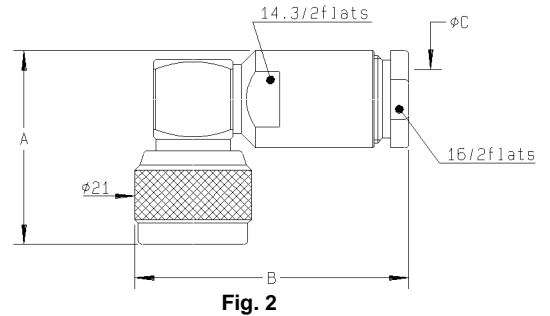
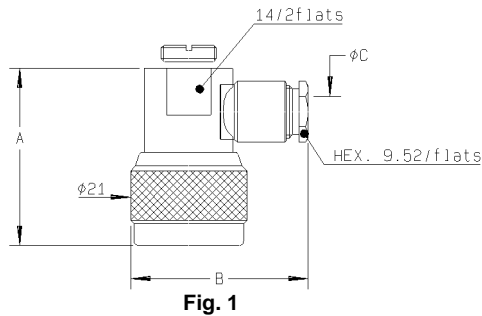

Cable group	Part number	Fig.	Dimensions (mm)			Captured center contact	Assembly instructions
			A	B	C		
5 / 50 / S + D	R161 157 000	1	32	32	5.6	yes	M15
10 + 11 / 50 / S + D	R161 168 000	2	34.85	49.4	11.2	yes	M16

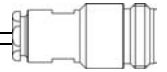

RIGHT ANGLE PLUG, SOLDER TYPE, FOR SEMI-RIGID CABLES

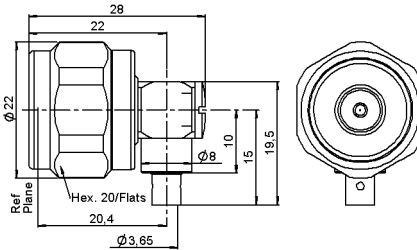

Cable group	Part number	Captured center contact	Assembly instructions
.141"	R161 152 107	yes	M17

RIGHT ANGLE PLUGS, EZ FIT TYPE, FOR CORRUGATED CABLES

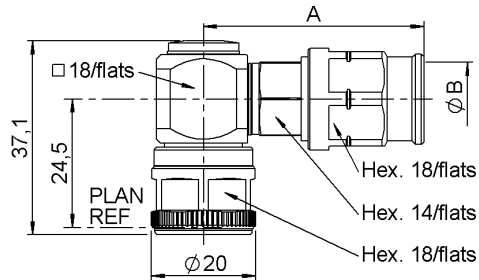

Cable group	Part number	Dimensions (mm)		Captured center contact	Assembly instructions
		A	B		
1/4" superflexible corrugated	R161 177 007	41.8	7.95	yes	M13
3/8" superflexible corrugated	R161 177 207	42.25	11	yes	M13
1/2" superflexible corrugated	R161 177 137	41.75	14	yes	M13

STRAIGHT JACKS, FULL CRIMP TYPE, FOR FLEXIBLE CABLES (single piece body)

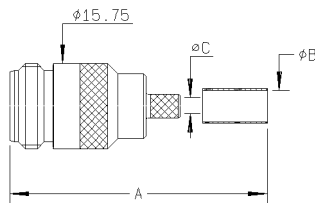

Fig. 1

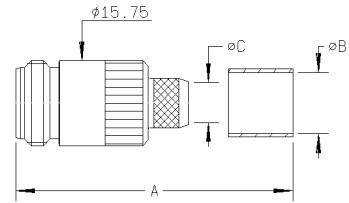
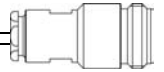

Fig. 2

Cable group	Part number	Fig.	Dimensions (mm)			Captured center contact	Assembly instructions
			A	B	C		
5 / 50 / S	R161 237 000	1	39.3	5.41	3.11	yes	M12
5 / 50 / D	R161 238 000	1	39.3	5.8	3.11	yes	M12
10 / 50 / S	R161 241 000	2	40.6	11.05	7.46	yes	M10
11 / 50 / D	R161 243 000	2	40.6	11.4	7.46	yes	M10



STRAIGHT JACKS, CLAMP TYPE, FOR FLEXIBLE CABLES

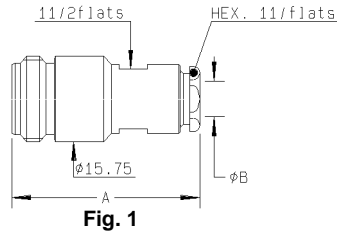
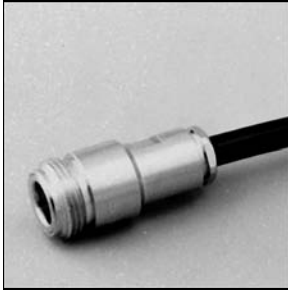

Fig. 1

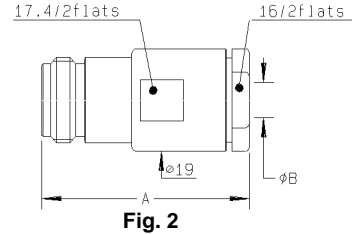

Fig. 2

Cable group	Part number	Fig.	Dimensions (mm)		Captured center contact	Assembly instructions
			A	B		
5 / 50 / S + D	R161 206 000	1	35.3	5.6	yes	M03
10 + 11 / 50 / S + D	R161 220 000	2	39.3	11.2	yes	M05
10 + 11 / 50 + 75 / S + D	R161 222 000	2	39.3	11.2	yes	M05

STRAIGHT JACKS, EZ FIT TYPE, FOR CORRUGATED CABLES

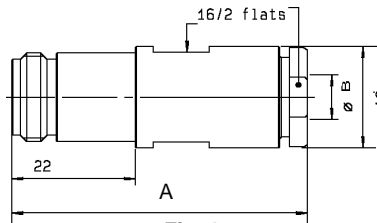

Fig. 1

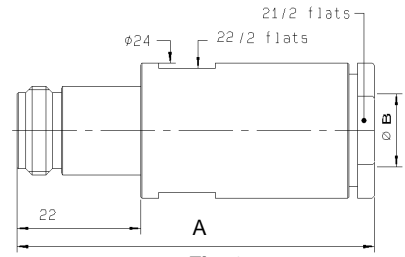

Fig. 2

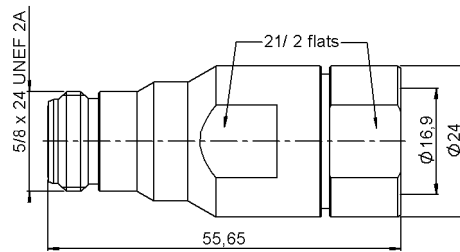

Fig. 3

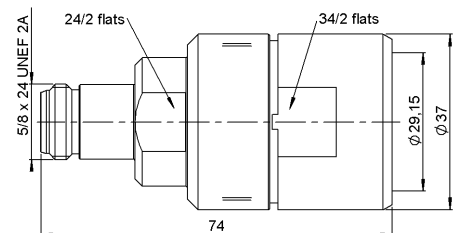

Fig. 4

Cable group	Part number	Fig.	Dimensions (mm)		Captured center contact	Assembly instructions
			A	B		
1/4" superflexible corrugated	R161 232 007	1	52.7	7.9	yes	M18
3/8" superflexible corrugated	R161 232 207	2	66	11	yes	M18
1/2" superflexible corrugated	R161 232 407	2	66	14	yes	M18
1/2" flexible corrugated	R161 230 320W	3			yes	M21
7/8" flexible corrugated	R161 231 020W	4			yes	M22



STRAIGHT JACKS, FOR SEMI RIGID CABLES

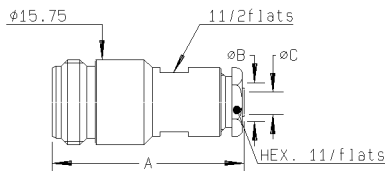

Fig. 1

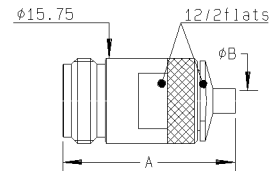
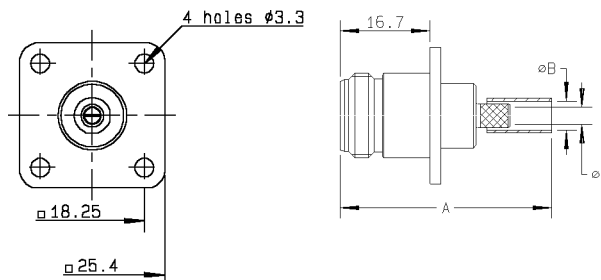
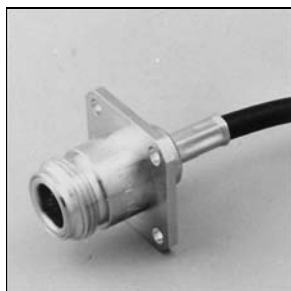

Fig. 2

Cable group	Part number	Fig.	Dimensions (mm)			Captured center contact	Assembly instructions	Note
			A	B	C			
.141"	R161 227 000	1	35.5	5.6	3.65	no	M06	Clamp type
.141"	R161 226 020	2	32	3.65		no	M14	Solder type

25.4 mm SQUARE FLANGE, STRAIGHT JACKS, FULL CRIMP TYPE, FOR FLEXIBLE CABLES (single piece body) (25.4 mm = 1 inch)



Cable group	Part number	Dimensions (mm)			Captured center contact	Assembly instructions	Panel drilling
		A	B	C			
5 / 50 / D	R161 283 000	39.3	5.8	3.11	yes	M12	P01
10 / 50 / S	R161 286 000	40.6	11.05	7.46	yes	M10	P01
11 / 50 / D	R161 286 200	40.6	11.4	7.46	yes	M10	P01

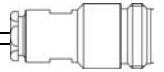

25.4 mm SQUARE FLANGE, STRAIGHT JACKS, CLAMP TYPE FOR FLEXIBLE CABLES (25.4 mm = 1 inch)

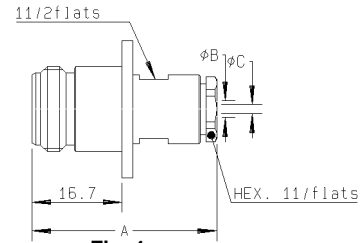
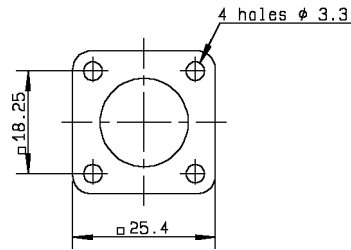

Fig. 1

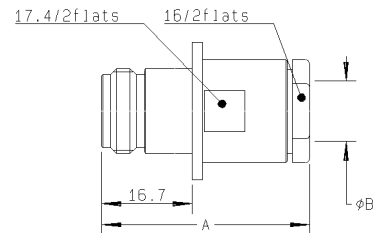

Fig. 2

Cable group	Part number	Fig.	Dimensions (mm)			Captured center contact	Assembly instructions	Panel drilling
			A	B	C			
2.6 / 50 / S + D	R161 252 000	1	34.3	3.1	1.7	yes	M01	P01
5 / 50 / S + D	R161 256 000	1	35.4	5.6		yes	M03	P01
10 + 11 / 50 / S + D	R161 270 000	2	39.3	11.2		yes	M05	P01

25.4 mm SQUARE FLANGE, STRAIGHT JACKS, EZ FIT TYPE, FOR CORRUGATED CABLES (25.4 mm = 1 inch)

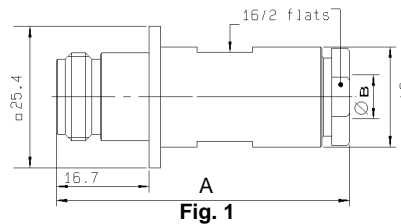
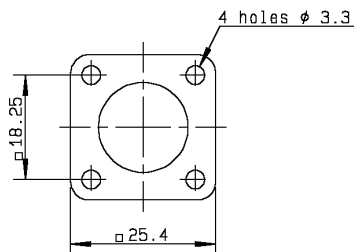

Fig. 1

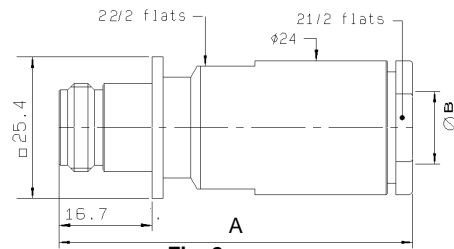
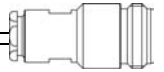

Fig. 2

Cable group	Part number	Fig.	Dimensions (mm)		Captured center contact	Assembly instructions	Panel drilling
			A	B			
1/4" superflexible corrugated	R161 279 007	1	52.7	7.9	yes	M18	P01
3/8" superflexible corrugated	R161 279 207	2	66	11	yes	M18	P01
1/2" superflexible corrugated	R161 279 407	2	66	14	yes	M18	P01



25.4 mm SQUARE FLANGE, STRAIGHT JACKS, FOR SEMI RIGID CABLES (25.4 mm = 1 inch)

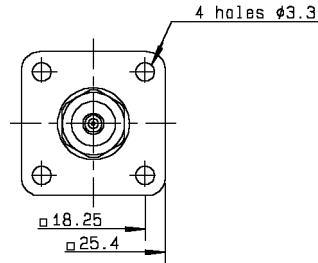

Fig. 1 & 2

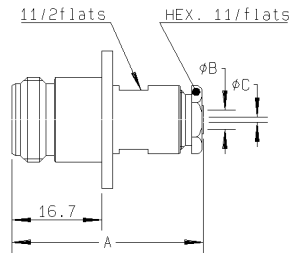

Fig. 1

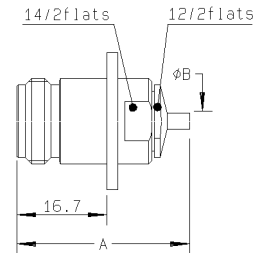

Fig. 2

Cable group	Part number	Fig.	Dimensions (mm)			Captured center contact	Assembly instructions	Panel drilling	Note
			A	B	C				
.141"	R161 277 000	1	35.5	5.6	3.65	no	M06	P01	Clamp type
.141"	R161 277 300	2	32	3.65		no	M14	P01	Solder type
.250"	R161 278 000	1	35.9	6.6		no	M06	P01	Clamp type

BULKHEAD STRAIGHT JACKS, FULL CRIMP TYPE, FOR FLEXIBLE CABLES (PANEL SEALED) (single piece body)

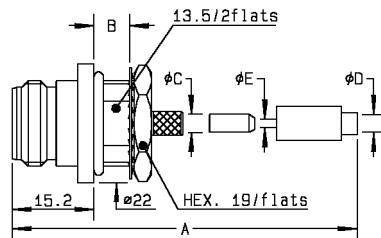

Fig. 1

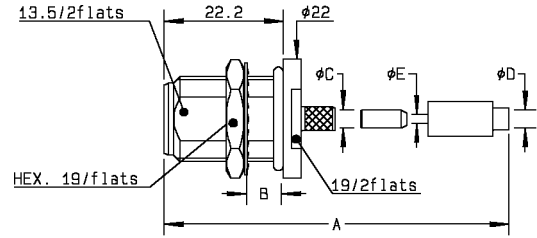

Fig. 2

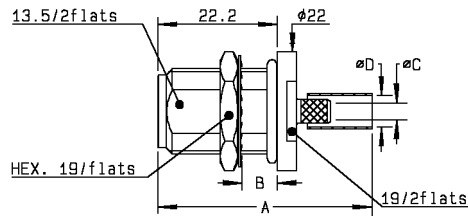
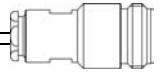

Fig. 3

Cable group	Part number	Fig.	Dimensions (mm)					Captured center contact	Assembly instructions	Panel drilling	Note
			A	B	C	D	E				
2.6 / 50 / S + D	R161 311 200	1	40.4	6.5	3.38	3.25	1.63	yes	M09	P14	Front mount
2.6 / 50 / S + D	R161 311 300	2						yes	M09	P14	Rear mount
5 / 50 / S	R161 329 000	3	39.8	6.5	3.11	5.41		yes	M12	P14	Rear mount
5 / 50 / D	R161 329 200					5.8		yes			



BULKHEAD STRAIGHT JACKS, CLAMP TYPE, FOR FLEXIBLE CABLES (PANEL SEALED)

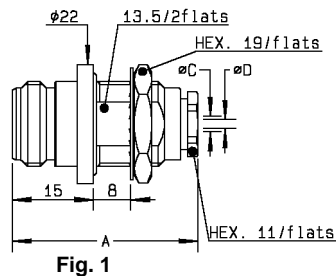

Fig. 1

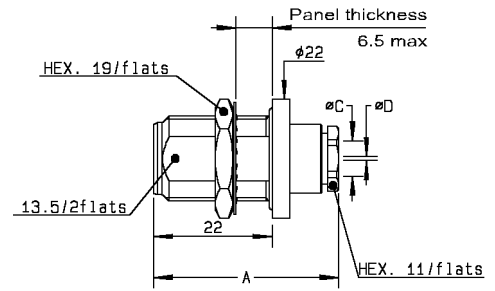

Fig. 2

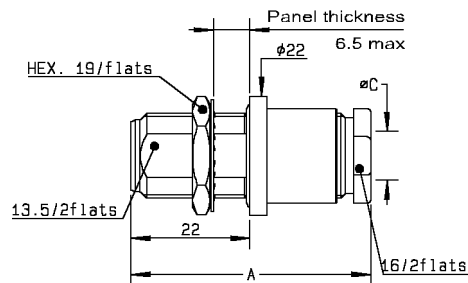

Fig. 3

Cable group	Part number	Fig.	Dimensions (mm)			Captured center contact	Assembly instructions	Panel drilling	Note
			A	C	D				
2.6 / 50 / S + D	R161 321 000	1	34.3	3.1	1.7	yes	M01	P14	Front mount
2.6 / 50 / S + D	R161 322 000	2	34.3	3.1	1.7	yes	M01	P14	Rear mount
5 / 50 / S + D	R161 325 000	2	35.4	5.6		yes	M03	P14	Rear mount
10 + 11 / 50 / S + D	R161 332 000	3	43	11.2		no	M04	P14	Rear mount

BULKHEAD STRAIGHT JACKS, EZ FIT TYPE, FOR CORRUGATED CABLES

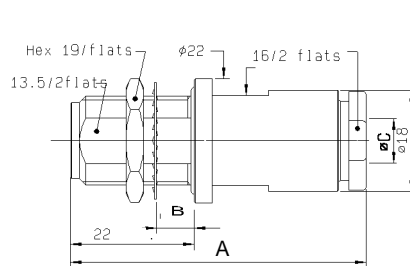

Fig. 1

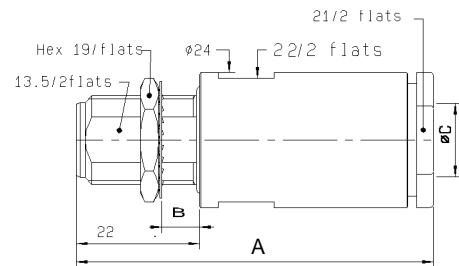
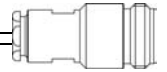

Fig. 2

Cable group	Part number	Fig.	Dimensions (mm)			Captured center contact	Assembly instructions	Panel drilling
			A	B	C			
1/4" superflexible corrugated	R161 341 007	1	52.7	6.5	7.9	yes	M18	P14
3/8" superflexible corrugated	R161 341 207	2	66	6.5	11	yes	M18	P14
1/2" superflexible corrugated	R161 341 407	2	66	6.5	14	yes	M18	P14



BULKHEAD STRAIGHT JACKS, FOR SEMI RIGID CABLES (PANEL SEALED)

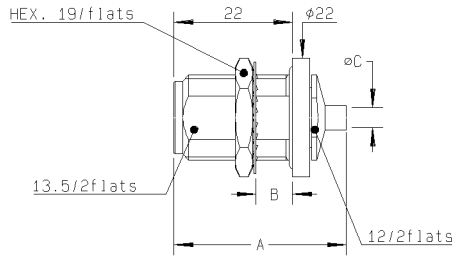
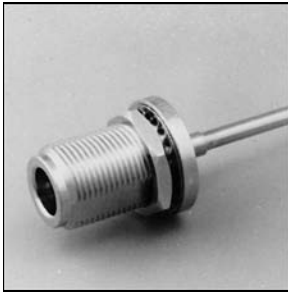

Fig. 1

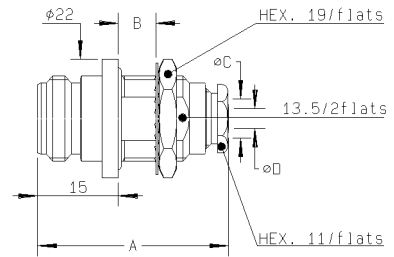

Fig. 2

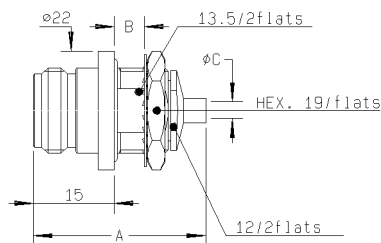

Fig. 3

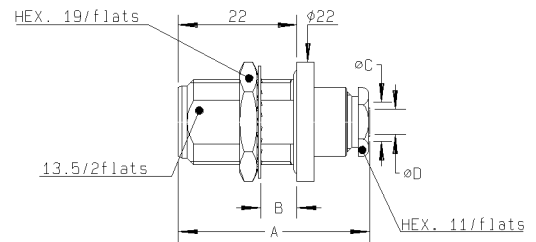
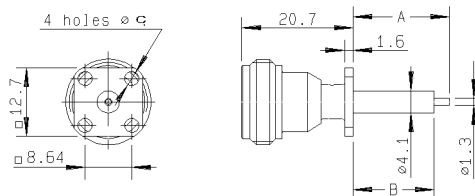

Fig. 4

Cable group	Part number	Fig.	Dimensions (mm)				Captured center contact	Assembly instructions	Panel drilling	Note
			A	B	C	D				
.085"	R161 335 200	1	32	6.5	2.25		no	M14	P14	Solder type / Rear mount
.141"	R161 323 000	2	35.5	8	5.6	3.65	no	M06	P14	Clamp type / Front mount
.141"	R161 323 200	4	35.5	6.5	5.6	3.65	yes	M06	P14	Clamp type / Rear mount
.141"	R161 336 000	1	32	6.5	3.65		no	M14	P14	Solder type / Rear mount
.141"	R161 336 200	3	32	6.5	3.65		no	M14	P14	Solder type / Front mount
.250"	R161 337 200	1	32	6.5	6.6		no	M14	P14	Solder type / Rear mount



12.7 mm (SMA) FLANGE, STRAIGHT FEMALE RECEPTACLES (12.7 mm = 1/2 inch)



Part number	Dimensions (mm)			Captured center contact	Panel drilling	Note
	A	B	C			
R161 410 520	17.9	15	2.9	yes	P11	Extended dielectric

17.5 mm FLANGE, STRAIGHT FEMALE RECEPTACLES (17.5 mm = 3/4 inch)

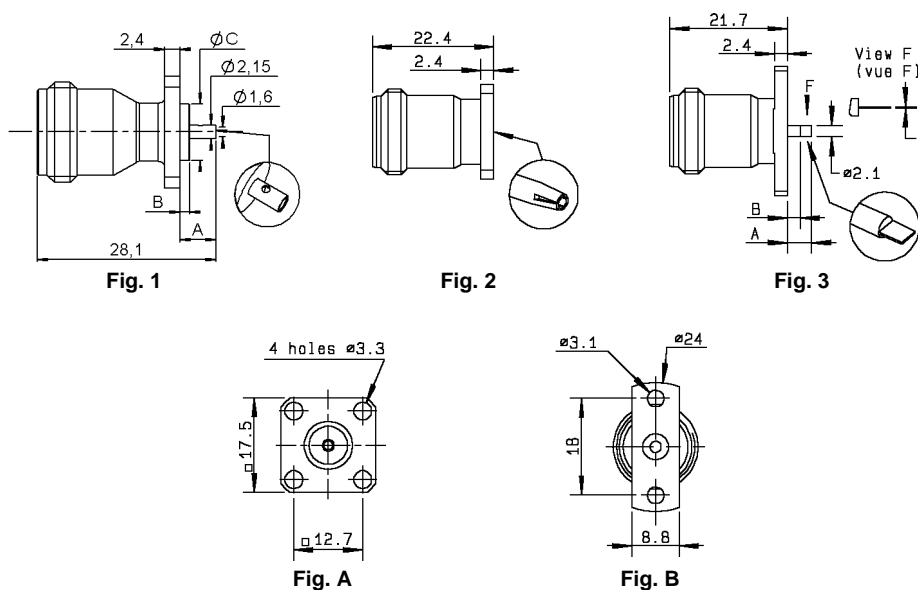

Part number	Fig.	Dimensions (mm)			Captured center contact	Panel drilling	Note
		A	B	C			
R161 410 000	1 + A	5.7	1.5	8.9	yes	P03	
R161 418 000	2 + A				yes	P03	Universal / see contacts page 27
R161 461 000	3 + B	6.2	3.9	0.6	yes	P12	2 hole flange / Flat tab contact



25.4 mm FLANGE, STRAIGHT MALE AND FEMALE RECEPTACLES (25.4 mm = 1 inch)

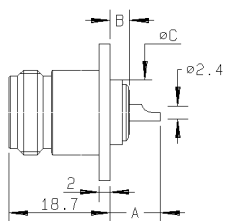

Fig. 1

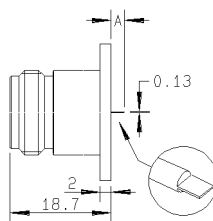

Fig. 2

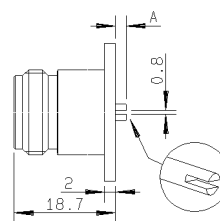

Fig. 3

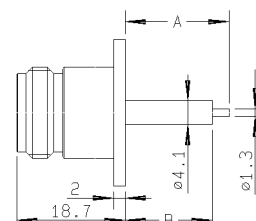

Fig. 4

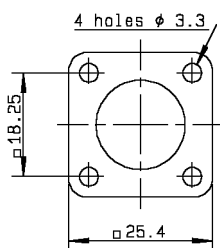

Fig. A

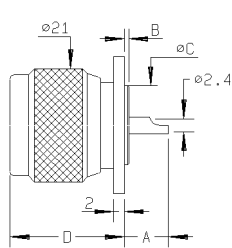

Fig. 5

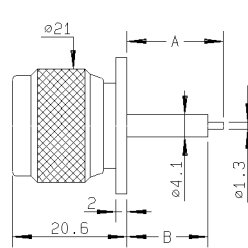

Fig. 6

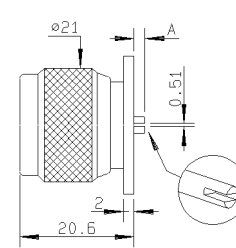
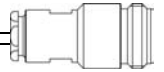
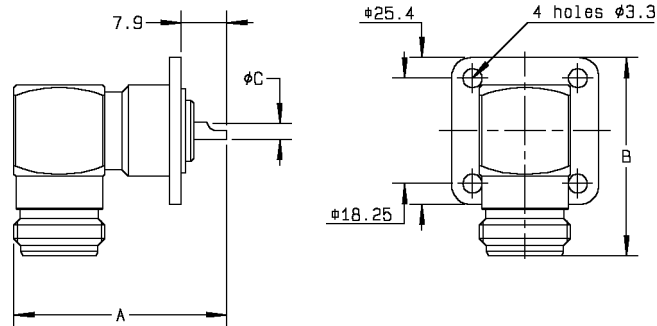
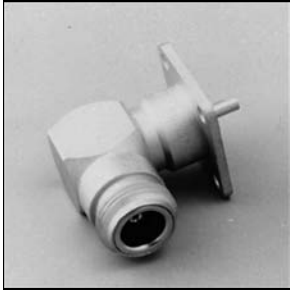

Fig. 7

Part number	Fig.	Dimensions (mm)				Captured center contact	Panel drilling	Note
		A	B	C	D			
R161 404 000	1 + A	9.3	0.8	14.6		yes	P07	Solder pot
R161 404 117	1 + A	9.3	2.5	14.6		yes	P07	Solder pot
R161 404 137	1 + A	9.3	0.8	14.6		yes	P07	For intermodulation application/Center contact brass
R161 412 020	1 + A	9.3	3.5	12		yes	P10	Solder pot
R161 416 130	4 + A	17.9	15			yes	P09	Extended dielectric
R161 419 020	2 + A	2.5				yes	P10	Flat tab contact
R161 419 300	3 + A	2				yes	P01	Slotted contact
R161 430 020	1 + A	6.5				yes	P10	Short back length
R161 440 020	5 + A	6	0		20.6	yes	P08	Male / solder pot
R161 441 000	5 + A	8.7	0.8	14.6	20.6	yes	P02	Male / solder pot
R161 441 400	6 + A	17.9	15			yes	P06	Male / extended dielectric
R161 444 037	7 + A	2				yes	P05	Male / slotted contact



25.4 mm FLANGE, RIGHT ANGLE FEMALE RECEPTACLE (25.4 mm = 1 inch)



Part number	Dimensions (mm)			Captured center contact	Panel drilling	Note
	A	B	C			
R161 653 000	36.9	34.4	2.5	yes	P02	Solder pot

BULKHEAD STRAIGHT RECEPTACLES (fully sealed or panel hermetic)

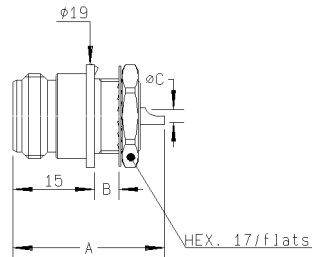

Fig. 1

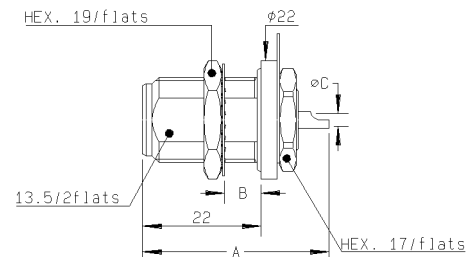

Fig. 2

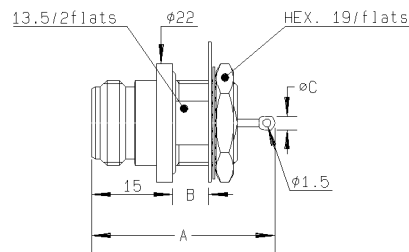
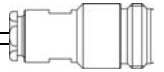

Fig. 3

Part number	Fig.	Dimensions (mm)			Captured center contact	Panel drilling	Note
		A	B	C			
R161 570 000	1	28	4.5	2.4	yes	P13	Front mount
R161 606 000	2	34.6	6.5	2.4	yes	P14	Rear mount /Fully sealed
R161 625 000	3	34	6.5	2.5	yes	P14	Front mount / Panel hermetic



IN SERIES ADAPTERS

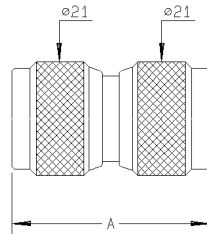

Fig. 1

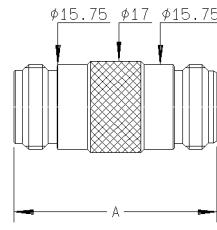

Fig. 2

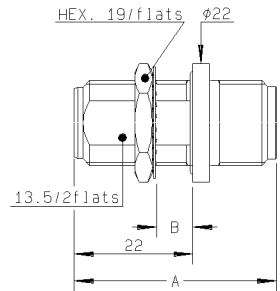

Fig. 4

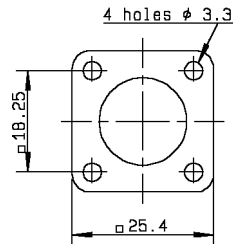

Fig. 3

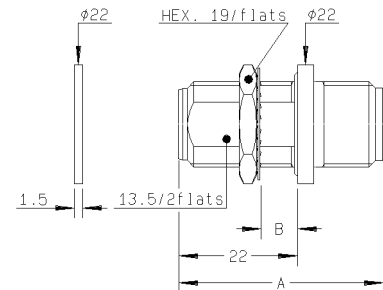
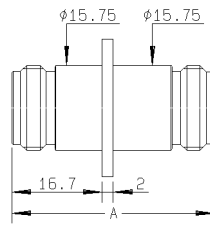

Fig. 5

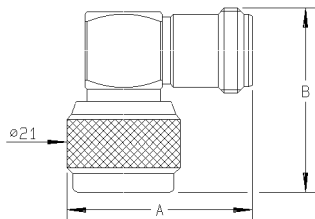

Fig. 6

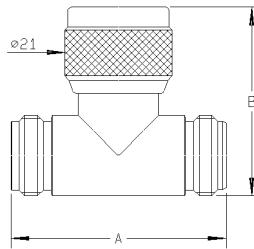

Fig. 7

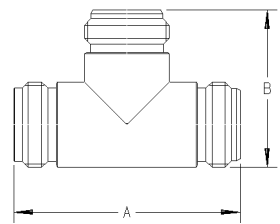

Fig. 8

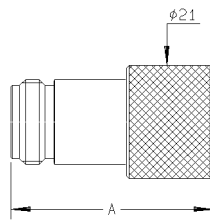

Fig. 9

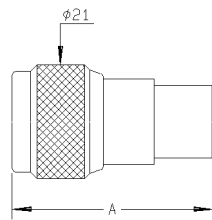

Fig. 10

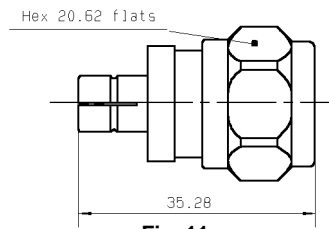
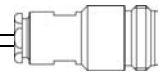

Fig. 11

Part number	Fig.	Dimensions (mm)		Panel drilling	Note
		A	B		
R161 703 000	1	36.7			M - M
R161 705 000	2	37.5			F - F
R161 715 000	3	37.5		P01	F - F / Flange
R161 730 000	4	37.5	6.5	P14	F - F / Bulkhead panel sealed
R161 753 000	5	38	6.5	P14	F - F / Hermetic / bulkhead
R161 771 000	6	34.4	34		M - F / Right-angle
R161 780 000	7	42	36.9		TEE F - F/M
R161 782 000	8	42	29.1		TEE F - F/F
R161 791 500	9	37.37			Push - on male / female screwing
R161 791 530	10	37.12			screwing male / Push - on female
R161 792 500*	11	37.12			Push - on male / male screwing

* Upon request



PROTECTIVE CAPS

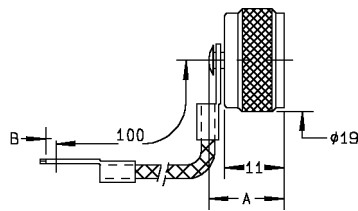

Fig. 1

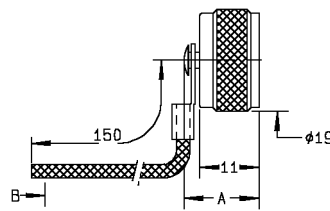

Fig. 2

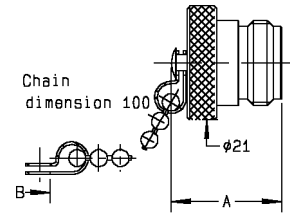

Fig. 3

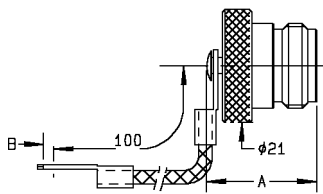

Fig. 4

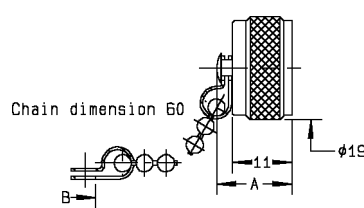

Fig. 5

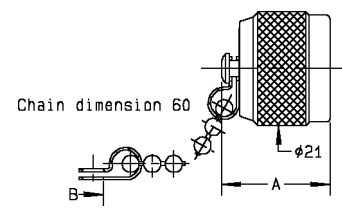
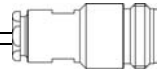

Fig. 6

Part number	Fig.	Dimensions (mm)		Note
		A	B	
R161 804 000	1	13.9	3.8	Male with cord
R161 805 410	2	13.9	2	Male with cord
R161 841 000	3	20.4	3.9	Female with chain
R161 844 000	4	20.4	3.8	Female with cord
R161 853 000	5	13.9	3.9	Male with chain
R161 862 000	6	20.1	3.9	Male short circuit with chain



FIELD-REPLACEABLE CONTACTS (For universal receptacle)

These accessories have been specifically designed for the adjustment at the rear of hermetically sealed universal receptacles.

The choice of their dimensions depends on the PCB or on the thickness of the MIC box. Moreover these contacts and insulators are also compatible with SMA UNIVERSAL RECEPTACLES.

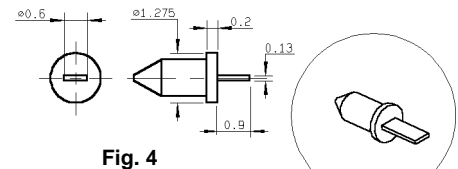
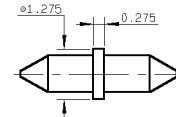
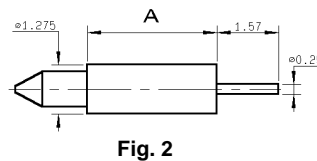
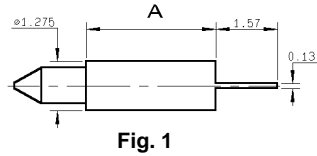
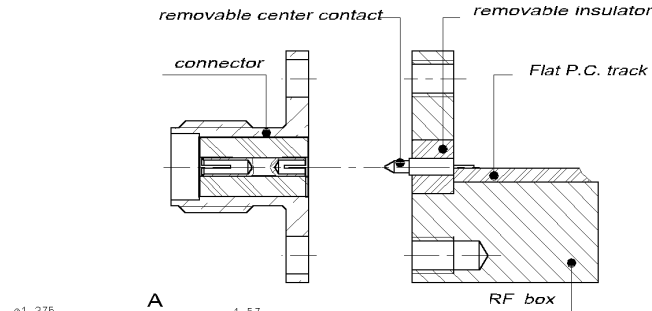

Part number	Fig.	A	Packaging	Note	Associated insulator P/N
R280 460 000	1	1.77	10	Flat tab	R280 467 0000
R280 461 000	1	3.37		Flat tab	R280 468 0000
R280 462 000	2	1.77		Cylindrical tab	R280 467 0000
R280 463 000	2	3.37		Cylindrical tab	R280 468 0000
R280 464 000*	3			Symmetrical	N/A
R280 465 000	4			Flat recessed tab	N/A

FIELD-REPLACEABLE INSULATORS

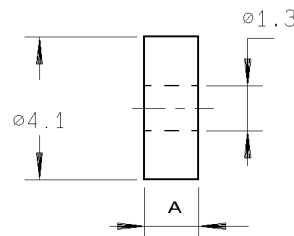

Part number	A	Packaging
R280 467 000	1.57	10
R280 468 000	3.17	10

* Upon request

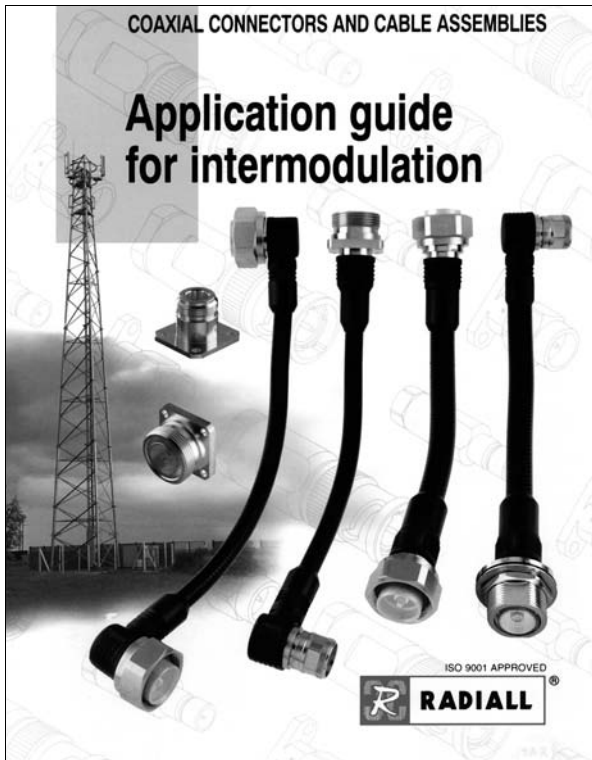
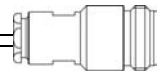

D1C 032 DE

What is INTERMODULATION ?

IM (abbreviation for InterModulation) is an undesired modulation which leads to a distortion of the output High Frequency carrier.

It is defined as the ratio of the 3rd order intermodulation products against the incident signal power because, the most troublesome IM products are those of 3rd order.

For more detailed information, please ask for our application guide where we present:

- our intermodulation measurement system,
- our product range.

BBR (**B**right **B**ronze **R**ADIALL) plating has been specifically developed and employed by RADIALL for its excellence in Intermodulation sensitive applications.

For more detailed information, an application guide about the BBR high quality plating is available upon request.



D1C 030 DE

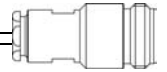

Radiall proposes you 3 types of cable assemblies with N type connectors.

This range includes standard and custom cable assemblies, offering you standard, main and high level of intermodulation performance (see our intermodulation application guide: **D1C 032 DE**).

- Standard level: **IMP3 = -90 dBm typical** (see page 30-31)

The main characteristics of this range are:

- cross-knurled coupling nut
- coupling torque 130 Ncm (with pliers R282 202 000)
- slotted outer contact
- plating: BBR (Bright Bronze Radiall)
- connectors also available uncabled
- 3 types of cable mounting: full crimp, clamp or solder

- Main level: **IMP3 = -110 dBm typical** (see page 32-33)

The main characteristics of this range are:

- hexagonal coupling nut (170 Ncm)
- non-slotted outer contact
- plating: silver (finish: strike of BBR)
- connectors also available uncabled (except for SHF cable)
- 3 types of cable mounting: full crimp, clamp or solder

- High level: **IMP3 = -125 dBm typical** (see page 34-35)

The main characteristics of this range are:

- hexagonal coupling nut (170 Ncm)
- non-slotted outer contact
- plating: silver (finish: strike of BBR)
- connectors only available for cable assemblies made by Radiall
- only solder type models: the most rigid cable attachment
- Intermodulation curves available upon request
- moisture resistance: IP 68 overmolding

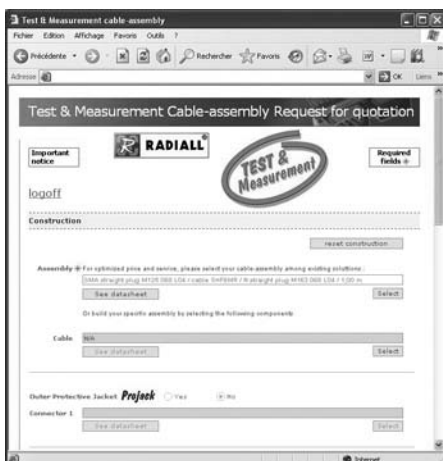
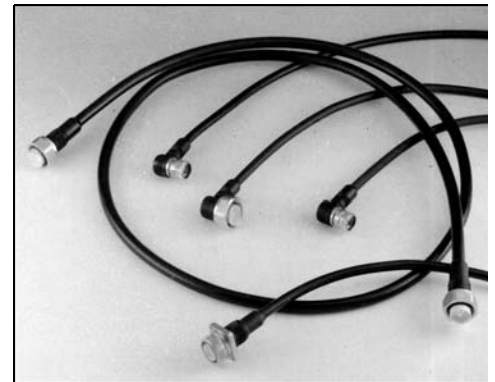

SERVICE + webtool: fast and reliable:

Your solution for RF & Microwave cable-assemblies on www.radiall.com

SIMPLE - FAST - EFFICIENT



CABLE ASSEMBLIES WITH STANDARD CONNECTORS (-90 dBm typ.) (-133 dBc typ./20W)

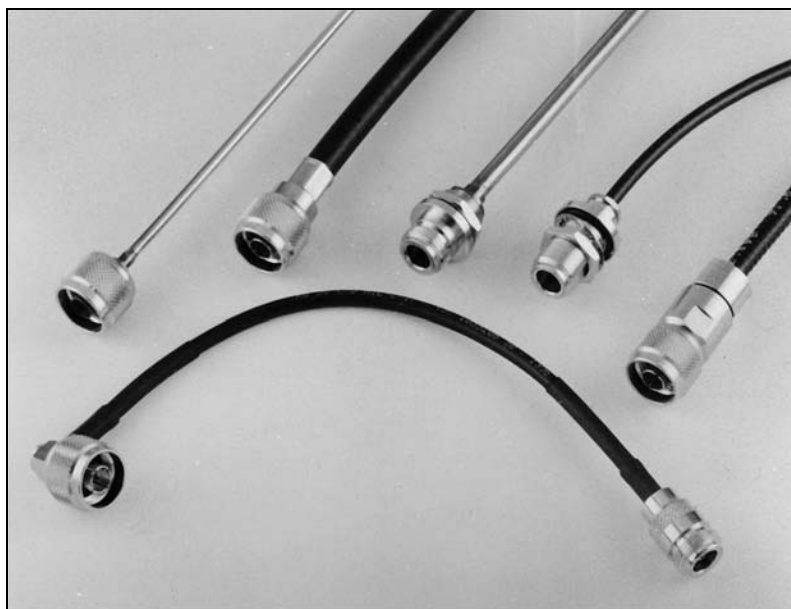

HOW TO ORDER

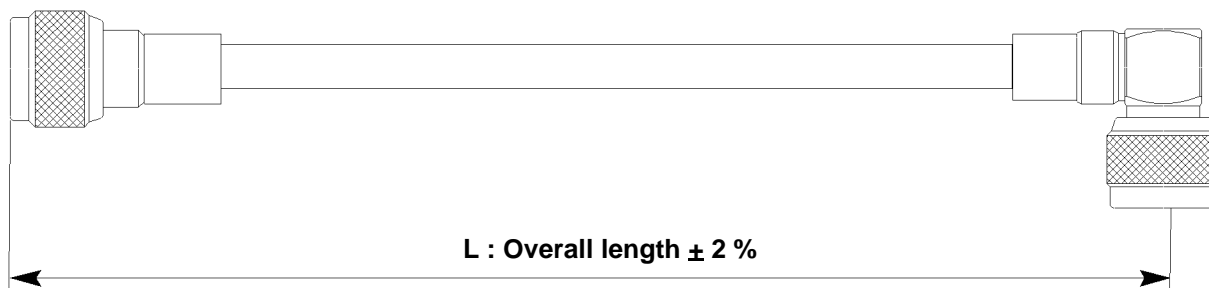

Example: Straight plug N / Cable 5/50 D RG223 / Right angle plug / length 100 cm

R161 083 000 / C291 330 000 / R161 183 000 / 100

Connector 1 part number (see table 1) _____

Coax cable part number (see table 2) _____

Connector 2 part number (see table 1) _____

Overall length in cm _____



CABLE ASSEMBLIES WITH STANDARD CONNECTORS (-90 dBm typ.) (-133 dBc typ./20W)

Table 1 Connectors part number guide

MODEL		SEMI-RIGID CABLES			FLEXIBLE CABLES						TIMES	
		.085"	.141"	.250"	2.6 / 50 S	2.6 / 50 D	5 / 50 S	5 / 50 D	10 / 50S	11 / 50 D	LMR 400	
Straight plug	Solder		R161 051 000	R161 054 000								
	Clamp		R161 052 000	R161 053 000	R161 004 000		R161 006 000 R161 010 000		R161 020 000 R161 022 000			
	Full crimp				R161 072 000		R161 082 000	R161 083 000	R161 075 000	R161 088 000	R161 075 060	
R/A plug	Clamp						R161 157 000		R161 168 000			
	Crimp						R161 182 000	R161 183 000	R161 184 000	R161 186 000	R161 184 036	
	Full crimp								R161 185 000	R161 187 000		
Straight jack	Solder		R161 226 020									
	Clamp						R161 206 000		R161 222 000 R161 220 000			
	Full crimp						R161 237 000	R161 238 000	R161 241 000	R161 243 000		
Straight bulkhead jack rear mount	Solder	R161 335 200	R161 336 000	R161 337 200								
	Clamp		R161 323 200		R161 321 000 R161 322 000		R161 325 000		R161 332 000			
	Full crimp				R161 311 300		R161 329 000	R161 329 200				
Straight bulkhead jack front mount	Solder											
	Clamp		R161 323 000 R161 323 020*		R161 321 000							
	Full crimp				R161 311 200							
Straight jack flange mount	Solder		R161 277 300									
	Clamp		R161 277 000	R161 278 000	R161 252 000		R161 256 000		R161 270 000			
	Full crimp							R161 283 000	R161 286 000	R161 286 200		

Table 2 Radial cable part number guide

	CABLE TYPE		P / N
SEMI-RIGID	.085"	RG 405	C291 850 001
	.141"	RG 402	C291 860 001
	.250"	RG 401	C291 870 001
FLEXIBLE	2 / 50 S	RG 178	C291 145 007
	2 / 50 D	FILOTEX	C291 146 087
	2.6 / 50 S	RG 174	C291 150 000
	2.6 / 50 D	OREBRO	C291 185 067
	5 / 50 S	RG 58	C291 305 000
	5 / 50 D	RG 223	C291 330 000
	10 / 50 S	RG 213	C291 510 000
TIMES	11 / 50 D	RG 214	C291 600 000
	5 / 50 S	LMR 200	C291 316 070
	10.3 / 50 S	LMR 400	C291 516 070
	15.2 / 50 S	LMR 600	C291 626 070

• Manufactured upon request

All our bulkhead mount jacks are panel sealed



CABLE ASSEMBLIES WITH LOW INTERMODULATION CONNECTORS (-110 dBm typ.) (-153 dBc typ./20W)



HOW TO ORDER

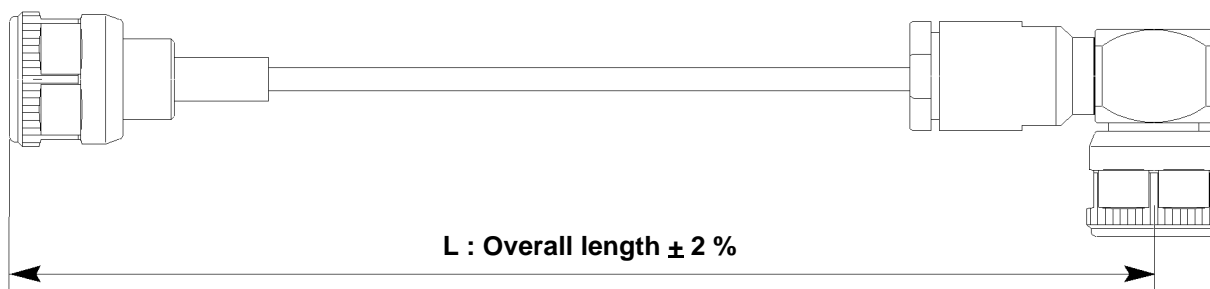

Example: Straight plug N / Cable 11 / 50 D RG 214 / Right angle plug N / length 100 cm

R161 088 137 / C291 600 000 / R161 186 137 / 100

Connector 1 part number (see table 1) _____

Coax cable part number (see table 2) _____

Connector 2 part number (see table 1) _____

Overall length in cm _____



CABLE ASSEMBLIES WITH LOW INTERMODULATION CONNECTORS (-110 dBm typ.) (-153 dBc typ./20W)

Table 1 Connectors part number guide

SERIES	MODEL		CABLES		SUPER FLEXIBLE CABLES		
			5 / 50 D	11 / 50 D	1/4"	3/8"	1/2"
N	Straight plug	Full crimp Clamp	R161 083 137	R161 088 137	R161 036 007	R161 036 207	R161 037 020
			R161 183 137	R161 186 137			
	R/A plug	Crimp Clamp			R161 177 007	R161 177 207	R161 177 137
	Straight jack	Clamp			R161 232 007	R161 232 207	R161 232 407
	Straight bulkhead jack	Clamp			R161 341 007	R161 341 207	R161 341 407
	Straight flange mount jack	Clamp			R161 279 007	R161 279 207	R161 279 407

All these connectors are also available unassembled, except models for SHF cables only sold on cable assemblies made by RADIALL.

Table 2 Radiall cable part number guide

CABLE TYPE			P / N
SEMI-RIGID	.141"	RG 405	C291 860 001
FLEXIBLE	5 / 50 D	RG 223	C291 330 000
	11 / 50 D	RG 214	C291 600 000
(PTFE) FLEXIBLE	5 / 50 D	RG 400	C291 326 007
	10 / 50 D	RG 393	C291 511 007
CORRUGATED	1/4" superflexible corrugated	High flexible CELLFLEX	C291 993 170
		HELIAX	C291 993 070
	3/8" superflexible corrugated	High flexible CELLFLEX	C291 996 170
		HELIAX	C291 996 070
	1/2" superflexible corrugated	High flexible CELLFLEX	C291 994 170
		HELIAX	C291 994 070
SHF*	5 TD	RADIALL	C291 999 902
	5 LI		C291 955 192



VERY LOW INTERMODULATION CABLE ASSEMBLIES (-125 dBm typ.) (-165 dBc typ./20W)

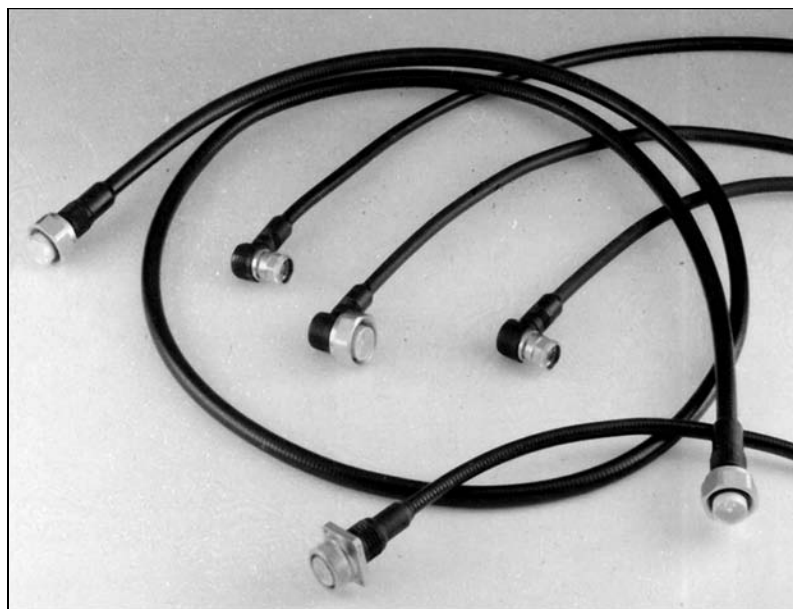

HOW TO ORDER

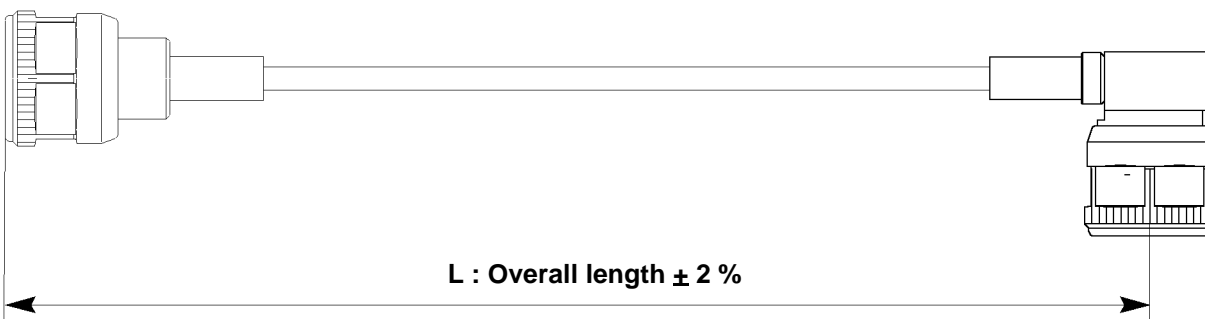

Example: Straight plug N / Cable 1/4" high flexible Cellflex / right angle plug N / length 50 cm

865 48 030 / C291 993 170 / 865 48 040 / 50

Connector 1 part number (see table 1) _____

Coax cable part number (see table 2) _____

Connector 2 part number (see table 1) _____

Overall length in cm _____

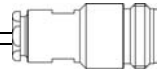

VERY LOW INTERMODULATION CABLE ASSEMBLIES (-125 dBm typ.) (-165 dBc typ./20W)

Table 1 Connectors part number guide

SERIES	MODEL Solder Type	SUPERFLEXIBLE CORRUGATED			SEMI-RIGID	(PTFE) FLEXIBLE	
		1/4"	3/8"	1/2"	.141"	RG 400	RG 393
N	Straight plug	865 48 030	865 48 080	865 48 120	865 48 000	Please consult us	
	R/A plug	865 48 040	865 48 090	865 48 130	865 48 010		
	Straight jack	865 48 050	865 48 100	865 48 140			
	Straight panel sealed bulkhead jack	865 48 060	865 48 110	865 48 150	865 48 020		
	Straight flange mount jack	865 48 070	865 48 170	865 48 160			

These connectors are only available for cable assemblies made by Radiall.

Table 2 Cable assemblies with standard lengths

CONNECTOR 1		CABLE		CONNECTOR 2		CABLE ASSEMBLY	Fig	
Series	Model	Type	Length (m)	Series	Model	P / N		
N	Straight plug	3/8" superflexible corrugated	1.5	N	Straight plug	R285 780 063	1	
		1/2" superflexible corrugated				R285 780 083		
		R/A plug				3/8" superflexible corrugated	R/A plug	R285 783 063
	Straight plug	3/8" superflexible corrugated	1.5	7/16	Straight flange jack	R285 786 063	3	
						Straight plug	R285 720 063	4
							R285 720 083	
							R285 725 063	5
	R/A plug	1/2" superflexible corrugated	1	Straight flange jack	R285 725 083			
		1/4" superflexible corrugated			R285 724 042	6		

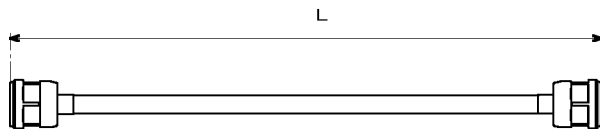

Fig. 1

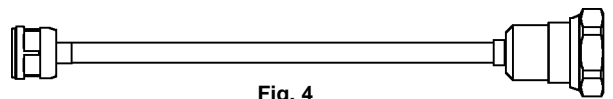

Fig. 4

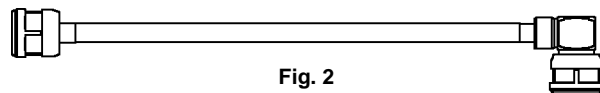

Fig. 2

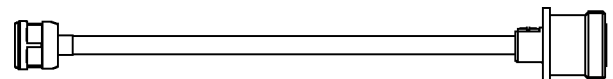

Fig. 5

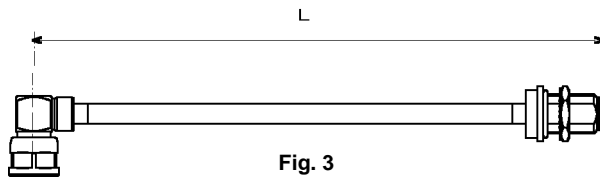

Fig. 3

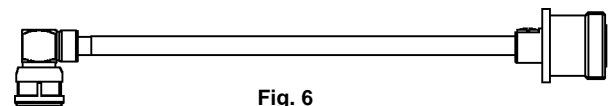
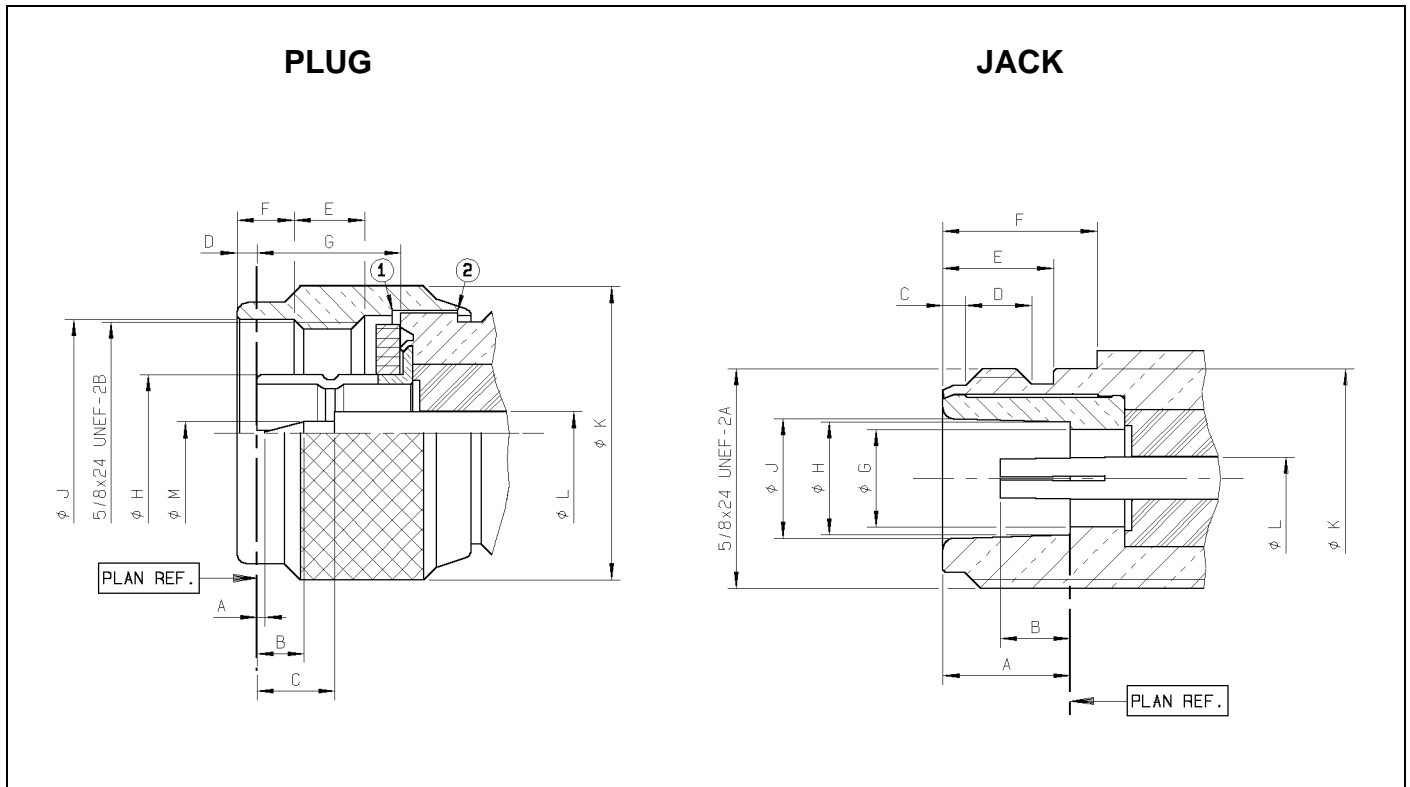
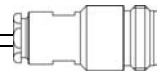

Fig. 6



LETTER	mm		inch	
	min.	max.	min.	max.
A	0.13	1.03	.005	.13
B	2.80	3.56	.110	.140
C	5.33	5.83	.210	.230
D	1	2	.016	.066
E	4.54	5.39	.179	.212
F	4.05	4.20	.159	.165
G	10.23	10.43	.403	.411
H DIA	8.27	8.37	.326	.329
J DIA	16.1	16.2	.634	.638
K DIA	20.9	21	.823	.827
L DIA	1.96	2	.077	.079
M DIA	0.87	0.91	.034	.036

LETTER	mm		inch	
	min.	max.	min.	max.
A	9.05	9.19	.356	.362
B	4.75	5.25	.187	.207
C	1.20	1.95	.047	.077
D	4.4	5.1	.173	.201
E	6.8	9	.268	.354
F	10.9	11.2	.429	.441
G DIA	6.98	7.02	.275	.276
H DIA	8.03	8.13	.316	.320
J DIA	8.53	8.73	.336	.344
K DIA	15.65	15.85	.616	.624
L DIA	1.96	2	.077	.079

IMPORTANT: the 50 Ω and the 75 Ω connectors are **NOT INTERMATEABLE**, resulting in the interface destruction

* statistics dimensions: .0539 .0055 (.0594 max)/(1.37 0.14)(1.51 max)

1) Coupling nut against on datum 1

2) Coupling nut against on datum 2



TEST/CHARACTERISTICS	STANDARD REFERENCE	VALUES/REMARKS
----------------------	--------------------	----------------

ELECTRICAL CHARACTERISTICS

Impedance		75 Ω
Frequency range		DC - 1.5 GHz
V.S.W.R. (typical)	Cable 6/75 Cable 10 +11/75	1.06 1.10
Insertion loss	straight connector right-angle connector	MIL < 0.15 dB
RF Leakage		MIL - 90 dB min at 1 GHz
Insulation resistance		MIL 5000 MΩ min
Contact resistance	center contact outer contact	MIL Initial 1 mΩ 0.2 mΩ After tests 1.5 mΩ -
Working voltage in VRMS	at sea level (at 70, 000 feet)	CECC Cable 10 + 11/75: 1400 (400) Cable 6/75: 850 (250)
Dielectric withstanding voltage in VRMS	at sea level (at 70, 000 feet)	CECC Cable 10 + 11/75: 2500 (600) Cable 6/75: 1500 (350)
RF testing voltage	sea level	CECC 1500 VRMS (5 MHz sine wave)

MECHANICAL CHARACTERISTICS

Durability		CECC 500 matings
Force to engage and disengage		CECC 6.6 Ncm max (.58 Inch-pounds)
Recommended coupling nut torque		40 to 60 Ncm (manual) 130 Ncm (11.45 inch pounds) (with pliers R282 202 000)
Proof torque		CECC 170 Ncm (14.96 inch pounds)
Coupling nut retention force		CECC 450 N (101.25 Lbs)
Cable retention force	cable 6/75 cable 10 +11/75	CECC 200 N 300 N
Center contact retention force	axial	MIL 27 N (6.08 Lbs)

ENVIRONMENTAL CHARACTERISTICS

Temperature range		CECC - 55°C + 155°C
Thermo cycling test		CECC - 55°C / + 155°C / 21 j
Thermal shock		CECC - 40°C / + 155°C or - 40°C / + 85°C – 5 cycles
Hight temperature test		CECC 125°C / 1000 H
Corrosion salt spray		CECC 48 H
Vibration		CECC Sinus 10 g / 10 – 500 Hz
Shock		CECC 1/2 Sinus 50g / 11 ms
Moisture resistance	clamp type crimp type	IEC 529 IP 67 IP 65 (with heatshrink sleeve)
Hermetic test		CECC 10-5 bar. cm ³ /s
Leakage		CECC Differential pressure 100 to 110 KPa: 1 bar cm ³ / H

MATERIALS

Body (nut) / center male contact / outer contact		Brass
Center female contact		Treated beryllium copper
Ferrule		Brass
Insulator		PTFE
Gasket		Silicon elastomer

PLATINGS

Body		BBR
Coupling nut / Design		BBR / cross knurled
Center contacts		Gold
Outer contacts / Design		BBR / slotted

Standard packaging = 50 pieces. For unit packaging add «W» after the P/N

All dimensions in mm



STRAIGHT PLUGS, CRIMP TYPE, FOR FLEXIBLE CABLES

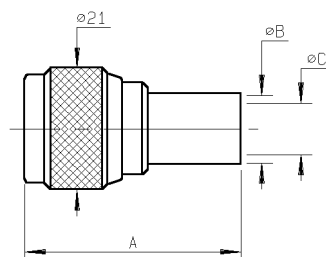

Cable group	Part number	Dimensions (mm)			Captured center contact	Assembly instructions
		A	B	C		
6 / 75 / S	R162 084 000	33.9	6.6	4	yes	M12
10 / 75 / S	R162 075 000	37.25	11.05	7.46	yes	M12
11 / 75 / D	R162 088 000	37.25	11.4	7.46	yes	M12

STRAIGHT PLUGS, CLAMP TYPE, FOR FLEXIBLE CABLES

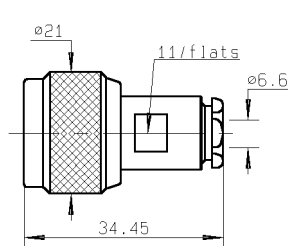

Fig. 1

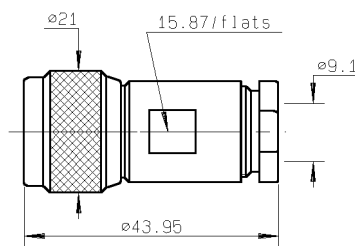

Fig. 2

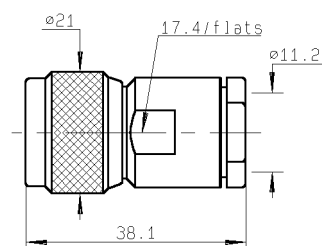
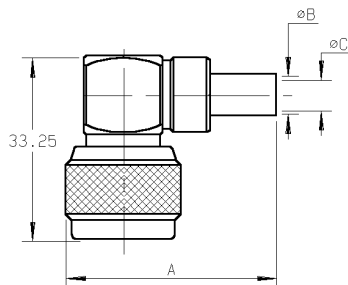

Fig. 3

Cable group	Part number	Fig.	Captured center contact	Assembly instructions
6 / 75 + 93	R162 012 000	1	no	M02
8 / 75 / D	R162 013 000	2	no	M16
10 + 11 / 75	R162 017 000	3	no	M04



RIGHT ANGLE PLUGS, CRIMP TYPE, FOR FLEXIBLE CABLES



Cable group	Part number	Dimensions (mm)			Captured center contact	Assembly instructions
		A	B	C		
6 / 75 / S	R162 184 000	38.25	6.6	4	yes	M12
10 / 75 / S	R162 185 000	42.25	11.05	7.46	yes	M12
11 / 75 / D	R162 187 000*	42.25	11.4	7.46	yes	M12

RIGHT ANGLE PLUGS, CLAMP TYPE, FOR FLEXIBLE CABLES

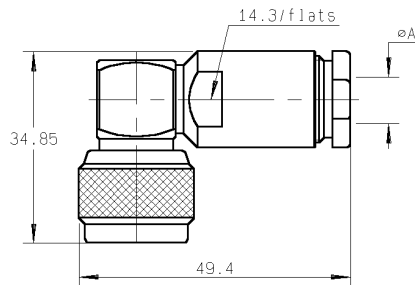
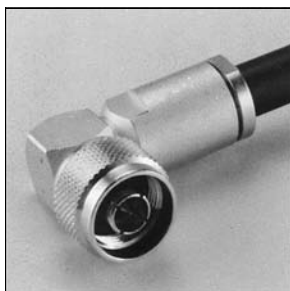

Cable group	Part number	Dimensions A (mm)	Captured center contact	Assembly instructions
6 / 75 + 93	R162 162 000	6.5	yes	M16
10 + 11 / 75	R162 168 000	11.2	yes	M16

* Upon request



STRAIGHT JACKS, CRIMP TYPE, FOR FLEXIBLE CABLES

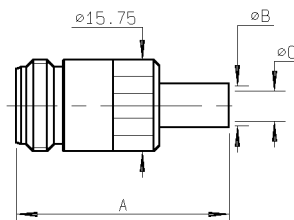

Cable group	Part number	Dimensions (mm)			Captured center contact	Assembly instructions
		A	B	C		
6 / 75 / S	R162 239 000	36.6	6.6	4	yes	M12
10 / 75 / S	R162 241 000*	40.6	11.05	7.46	yes	M12
11 / 75 / D	R162 243 000*	40.6	11.4	7.46	yes	M12

STRAIGHT JACKS, CLAMP TYPE, FOR FLEXIBLE CABLES

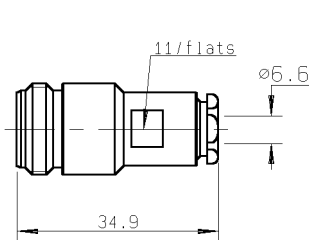
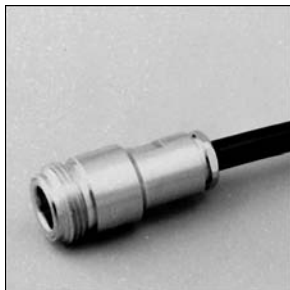

Fig. 1

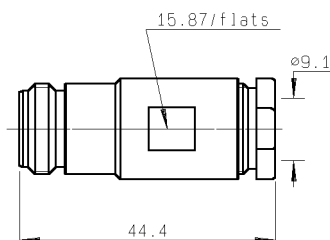

Fig. 2

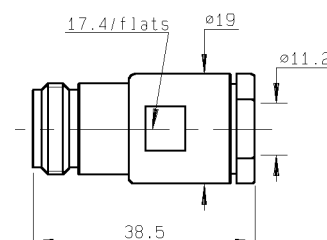
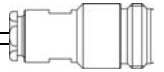

Fig. 3

Cable group	Part number	Fig.	Captured center contact	Assembly instructions
6 / 75 + 93 / S	R162 212 000*	1	no	M02
8 / 75 / D	R162 213 000*	2	no	M16
10 + 11 / 75	R162 217 000	3	no	M04

• Upon request



SQUARE FLANGE STRAIGHT JACKS, CLAMP TYPE, FOR FLEXIBLE CABLES

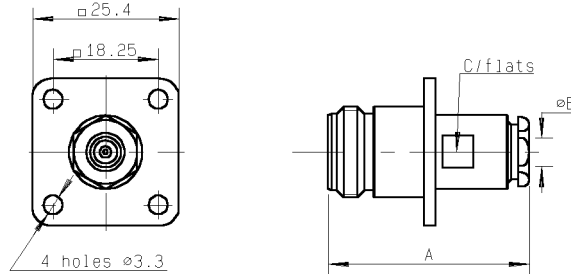

Cable group	Part number	Dimensions (mm)			Captured center contact	Assembly instructions	Panel drilling
		A	B	C			
6 / 75 + 93 / S	R162 262 000	34.9	6.6	11	no	M02	P01
10 + 11 / 75	R162 267 000	38.5	11.2	17.4	no	M04	P01

STRAIGHT BULKHEAD JACKS, CRIMP TYPE, FOR FLEXIBLE CABLES

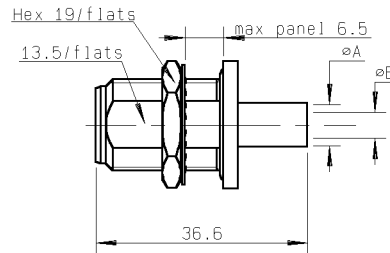

Cable group	Part number	Dimensions (mm)		Captured center contact	Assembly instructions	Panel drilling
		A	B			
6 / 75 / S	R162 335 000*	6.6	4	yes	M12	P14
10 / 75 / S	R162 336 000	11.05	7.46	yes	M12	P14
11 / 75 / D	R162 339 000*	11.4	7.46	yes	M12	P14

STRAIGHT BULKHEAD JACKS, CLAMP TYPE, FOR FLEXIBLE CABLES

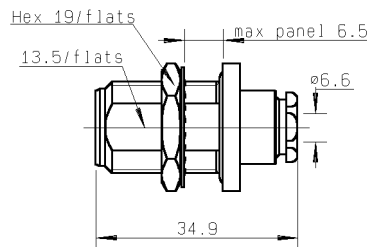

Fig. 1

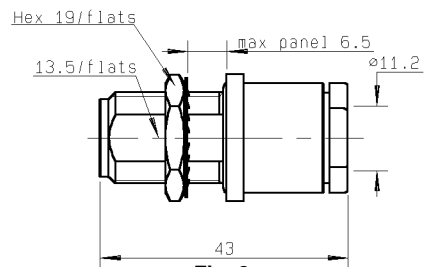

Fig. 2

Cable group	Part number	Fig.	Captured center contact	Assembly instructions	Panel drilling
6 / 75 + 93 / S	R162 328 000*	1	no	M02	P14
10 + 11 / 75	R162 332 000*	2	no	M04	P14

* Upon request



FEMALE RECEPTACLES

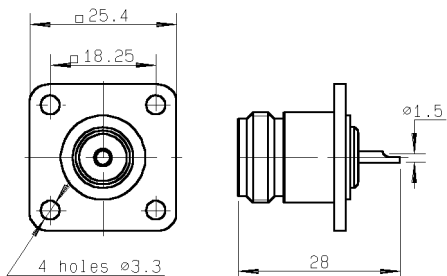

Fig. 1

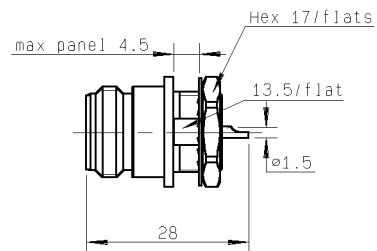

Fig. 2

Part number	Fig.	Captured center contact	Panel drilling
R162 403 000	1	yes	P07
R162 570 000	2	yes	P15

IN SERIES ADAPTERS

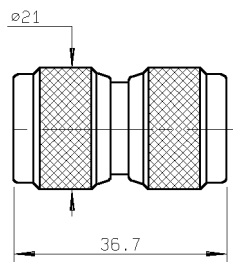

Fig. 1

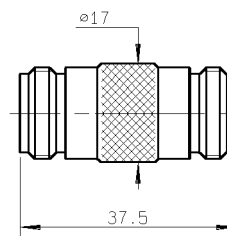
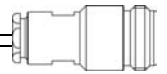
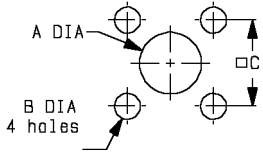
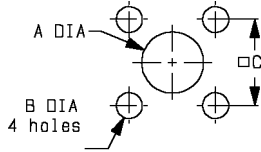

Fig. 2

Part number	Fig.	Captured center contact
R162 703 000	1	yes
R162 705 000	2	yes

P01

	MM		INCH	
	maxi	mini	maxi	mini
A	16.3	16.1	0.642	0.634
B	3.30	3.20	0.13	0.126
C	18.35	18.15	0.722	0.715

P02

	MM		INCH	
	maxi	mini	maxi	mini
A	15.1	14.9	0.594	0.587
B	3.30	3.20	0.13	0.126
C	18.35	18.15	0.722	0.715

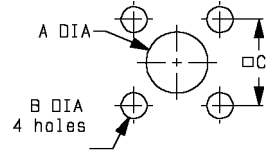
P03

	MM		INCH	
	maxi	mini	maxi	mini
A	9.40	9.20	0.37	0.362
B	3.30	3.20	0.13	0.126
C	12.8	12.6	0.504	0.496

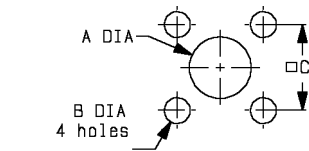
P04

	MM		INCH	
	maxi	mini	maxi	mini
Front	21.7	21.5	0.854	0.846
Rear	19.7	19.5	0.776	0.768
B	3.30	3.20	0.13	0.126
C	18.35	18.15	0.722	0.715

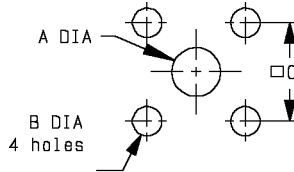
P05

	MM		INCH	
	maxi	mini	maxi	mini
A	7.1	7	0.279	0.275
B	3.4	3.3	0.134	0.13
C	18.35	18.15	0.722	0.715

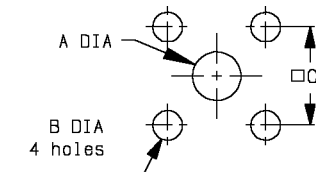
P06

	MM		INCH	
	maxi	mini	maxi	mini
A	4.2	4.1	0.165	0.161
B	3.3	3.2	0.13	0.126
C	18.35	18.15	0.722	0.715

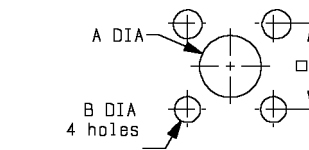
P07

	MM		INCH	
	maxi	mini	maxi	mini
Front	16.3	16.1	0.642	0.634
Rear	15.1	14.9	0.594	0.587
B	3.30	3.20	0.13	0.126
C	18.35	18.15	0.722	0.715

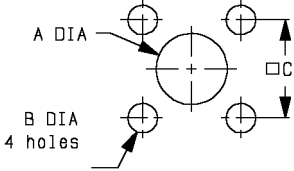
P08

	MM		INCH	
	maxi	mini	maxi	mini
A	12.5	12.3	0.492	0.484
B	3.3	3.2	0.13	0.126
C	18.35	18.15	0.722	0.715

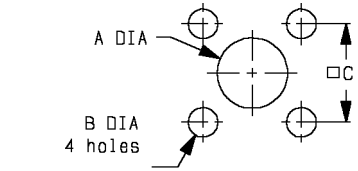
P09

	MM		INCH	
	maxi	mini	maxi	mini
Front	16.3	16.1	0.642	0.634
Rear	4.2	4.1	0.165	0.161
B	3.3	3.2	0.13	0.126
C	18.35	18.15	0.722	0.715

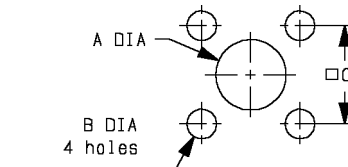
P10

	MM		INCH	
	maxi	mini	maxi	mini
Front	16.3	16.1	0.642	0.634
Rear	12.5	12.3	0.492	0.484
B	3.3	3.2	0.13	0.126
C	18.35	18.15	0.722	0.715

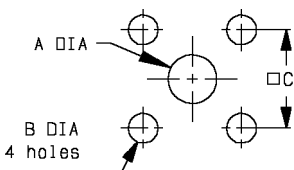
P11

	MM		INCH	
	maxi	mini	maxi	mini
A	4.2	4.1	0.165	0.161
B	2.7	2.6	0.106	0.102
C	8.69	8.59	0.342	0.338

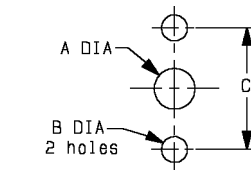
P12

	MM		INCH	
	maxi	mini	maxi	mini
A	5	4.80	0.197	0.189
B	3.30	3.20	0.13	0.126
C	18.1	17.9	0.713	0.705

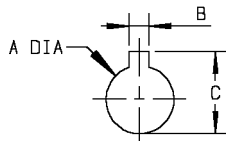
P13

	MM		INCH	
	maxi	mini	maxi	mini
A	14.3	14.1	0.563	0.555
B	2.30	2.20	0.091	0.087
C	17	16.8	0.669	0.661

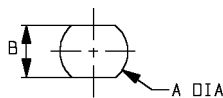
P14

	MM		INCH	
	maxi	mini	maxi	mini
A	16.1	16	0.634	0.63
B	13.7	13.6	0.539	0.535

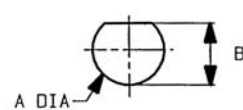
P15

	MM		INCH	
	maxi	mini	maxi	mini
A	14.3	14.1	0.563	0.56
B	13.8	13.6	0.543	0.538

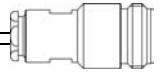

M 01

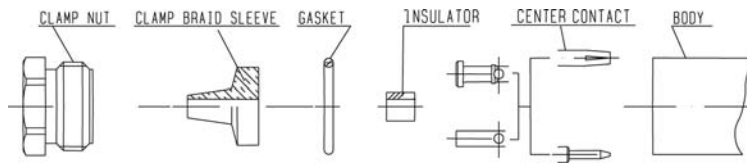

STRIPPING DIMENSIONS

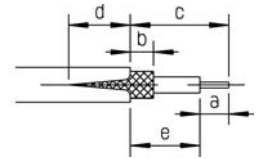

Part number	Stripping length (mm)				
	a	b	c	d	e
R161 004 000	4	2	8	2	4
R161 252 000					
R161 321 000					
R161 322 000					

1

- Slide clamp nut onto cable.
- Strip the cable.
- Cut the jacket (2 slots) apart if necessary.

3

- Solder the cable inner conductor into center contact.
- Slide the back nut over the clamp assembly.

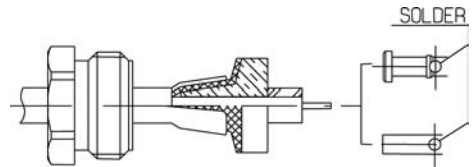

2

- Slide the clamp braid sleeve between cable dielectric and braid.
- Cut the braid flush with the clamp braid sleeve.
- Slide the insulator.

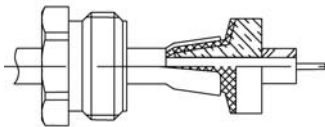

4

- Mount the gasket into the connector.
- Screw sub-assembly into the connector body. (recommended coupling torque 13.27 in.lb - 150 Ncm).

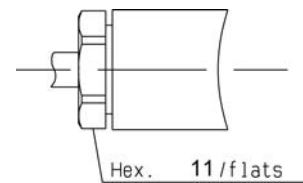

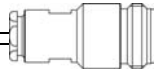

M 02

STRIPPING DIMENSIONS

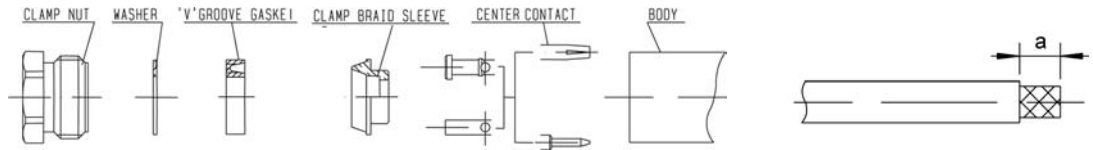

Part number	Stripping length (mm)		
	a	b	c
R161 006 000	7.5	4	1
R162 012 000 R162 262 000 R162 212 000 R162 328 000	8		2

1 - Strip the cable.

3 - Solder the cable inner conductor into center contact.

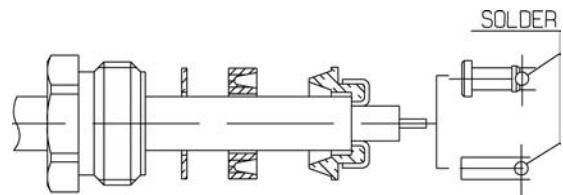

2 - Slide the clamp nut, the washer and the 'V' groove gasket onto the cable.
 - Slide clamp braid sleeve over braid.
 - Fold back braid and trim off excess of braid.
 - Trim back dielectric as shown.

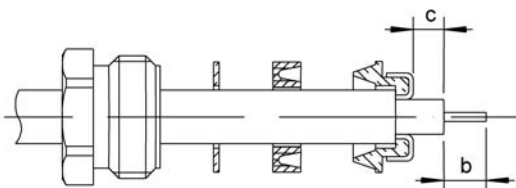

4 - Screw sub-assembly into the connector body. (recommended coupling torque 39.82 in.lb - 450 Ncm).

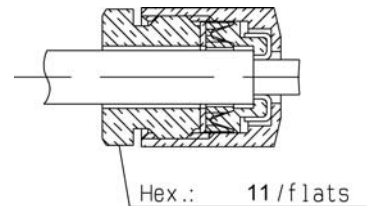

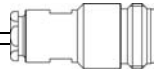

M 03

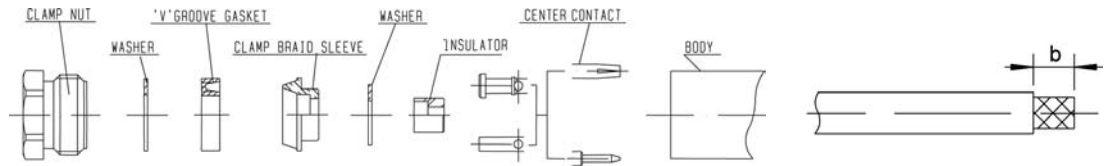

Part number	Stripping length (mm)			
	a	b	c	
R161 010 000	4	7.5	2	
R161 206 000			R161 325 000	1
R161 256 000				

1

- Strip the cable.

3

- Slide the washer and the insulator onto the dielectric.
- Solder the cable inner conductor into center contact.

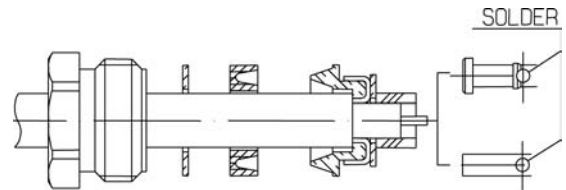

2

- Slide the clamp nut, the washer and the 'V' groove gasket onto the cable.
- Slide clamp braid sleeve over braid.
- Fold back braid and trim off excess of braid.
- Trim back dielectric as shown.

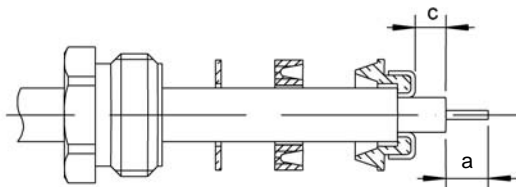

4

- Screw sub-assembly into the connector body. (recommended coupling torque 39.83 in.lb - 450 Ncm).

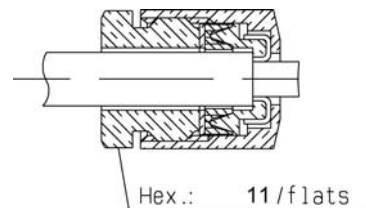

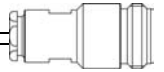

M 04

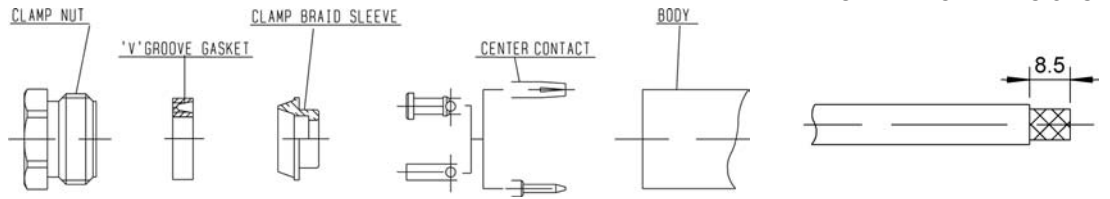

Part number		
R161 020 000	R162 017 000	R162 267 000
R161 332 000	R162 217 000	R162 332 000

1

- Strip the cable.

3

- Solder the cable inner conductor into center contact.

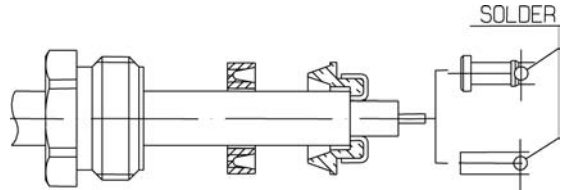

2

- Slide the clamp nut and the 'V' groove gasket onto the cable.
- Slide clamp braid sleeve over braid.
- Fold back braid and trim off excess of braid.
- Trim back dielectric as shown.

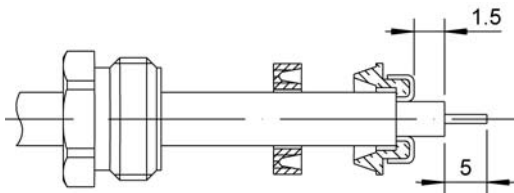

4

- Screw sub-assembly into the connector body. (recommended coupling torque 70.87 in.lb - 800 Ncm).

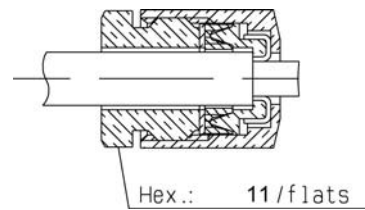

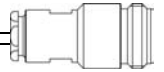

M 05

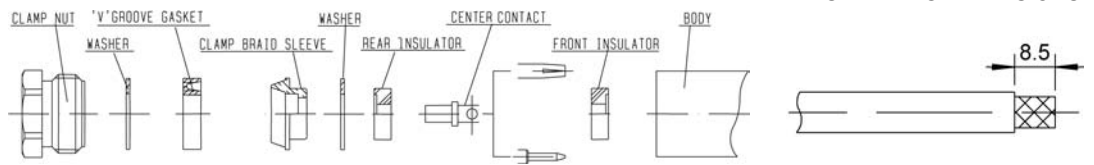

Part number	
R161 022 000	R161 222 000
R161 220 000	R161 270 000

- 1**
- Strip the cable.

- 3**
- Mount washer and rear insulator.
 - Solder the cable inner conductor into center contact.

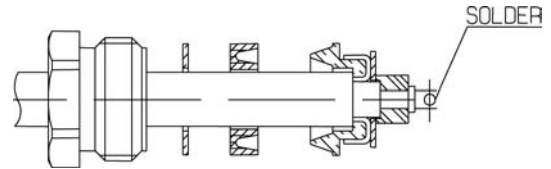

- 2**
- Slide the clamp nut, the washer and the 'V' groove gasket onto the cable.
 - Slide clamp braid sleeve over braid.
 - Fold back braid and trim off excess of braid.
 - Trim back dielectric as shown.

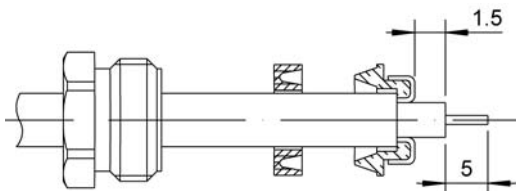

- 4**
- Mount front insulator.
 - Screw sub-assembly into the connector body. (recommended coupling torque 70.87 in.lb - 800 Ncm).

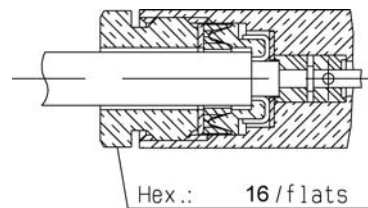

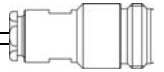

M 06

STRIPPING DIMENSIONS

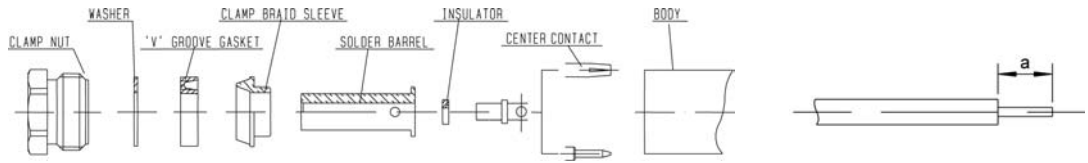

Part number	Stripping length (mm) a	Stripping tool	Trimmer	Solder barrel gauge	Positioner
R161 052 000	4.5	R282 053 000	R282 066 010	R282 744 320	R282 744 261
R161 053 000		R282 054 000	R282 074 020	R282 744 330	
R161 227 000 R161 277 000		R282 053 000	R282 066 010	R282 744 320	R282 744 260
R161 278 000		R282 054 000	R282 074 020	R282 744 330	
R161 323 000 R161 323 200		R282 053 000	R282 066 010	R282 744 320	

1

- Take the tool kit: R282 125 010 (or spare tools).
- Strip the dielectric of the cable with stripping tool.
- Trim cable center conductor with trimmer.
- Clean the cable.

2

- Slide the clamp nut, the washer, the 'V' groove gasket, the clamp braid sleeve and the solder barrel onto the cable.
- Position solder barrel flush against solder barrel gauge and solder to the cable or align with outer the conductor.

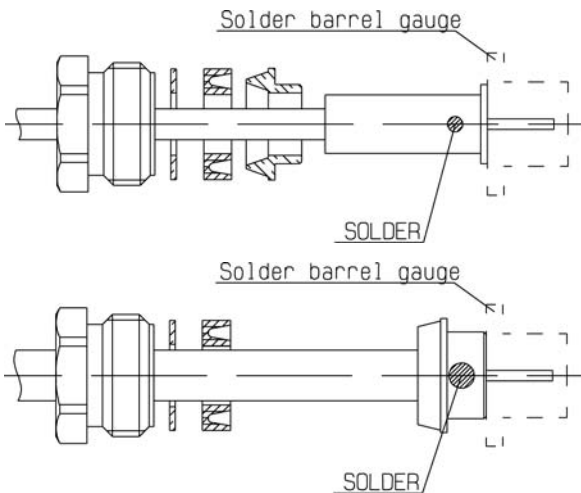

3

- Once cooled, remove the solder barrel gauge.
- Cut the dielectric flush to clamp braid sleeve.
- Slide the insulator onto the cable inner conductor.
- Slide the center contact onto the cable inner conductor against insulator.
- Fit the cable assembly onto the soldering jig R282 740 030 and the positioner.
- Tighten cable and solder the center contact.

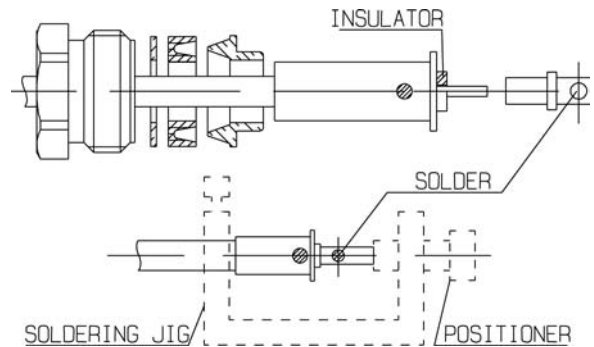

4

- Screw sub-assembly into the connector body. (recommended coupling torque 22.12 in.lb - 250 Ncm).

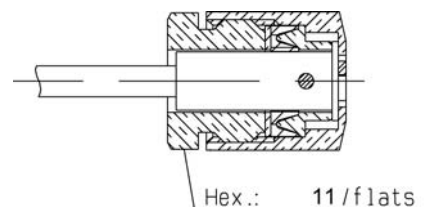

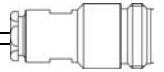

M 07

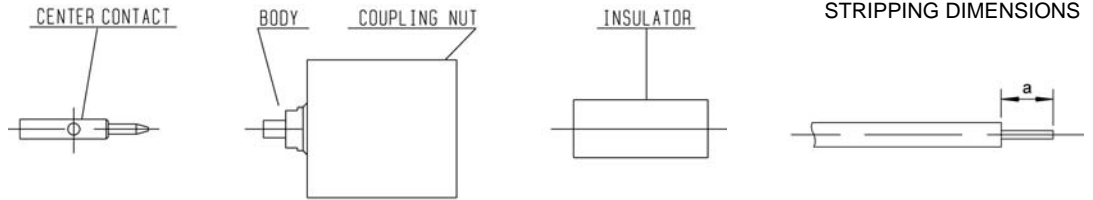

Part number	Stripping length (mm) a	Stripping tool	Trimmer	Solder gauge [thickness b]	Positioner	Dielectric insertion tool + plunger	Dielectric recess tool
R161 051 000	4.5	R282 053 000	R282 066 010	R282 862 070 [0.35]	R282 744 340	R282 730 161	R282 915 030
R161 054 000		R282 054 000	R282 074 020	R282 862 080 [0.45]	R282 744 350	R282 730 160	R282 915 040

- 1**
- Take the tool kit : R282 125 010 (or spare tools).
 - Strip the dielectric of the cable with stripping tool cable.
 - Trim the cable center conductor with trimmer
 - Clean the cable.

- 2**
- Screw the positioner R282 744 261 onto the soldering jig R282 740 030.
 - Slide contact into positioner.
 - Insert solder gauge between contact and cable
 - Tighten and solder the contact.

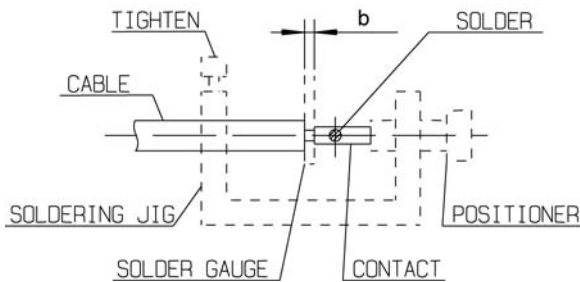

- 3**
- After cooling remove cable assembly from the jig.
 - Screw positioner into the connector.
 - Slide cable into the connector until it bottoms against positioner.
 - Tighten.
 - Put 3 rings of solder around the cable and solder.

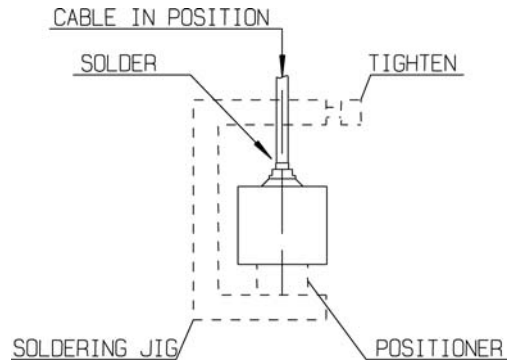

- 4**
- After cooling remove cable assembly from the jig.
 - Screw female dielectric insert tool onto connector and cut the excess of dielectric with the dielectric recess tool.
 - Insert insulator with the dielectric plunger.

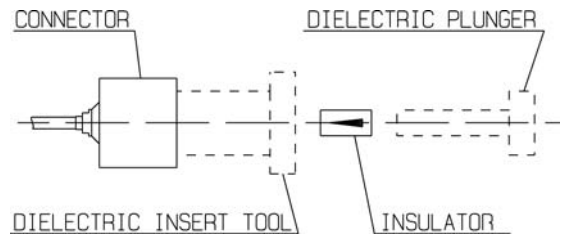

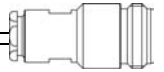

M 08

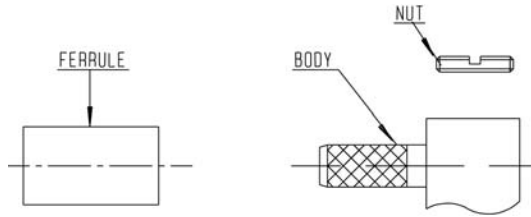

STRIPPING DIMENSIONS

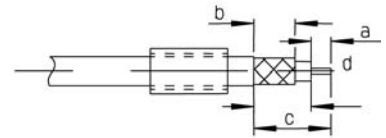

Part number	Stripping length(mm)				Crimping tool	
	a	b	c	d	Dies included	MIL standard R282 293 000 (M22520/5-01) + Dies
R161 182 000 R161 183 000 R161 183 137	3.5	7	18	14.5	R282 223 000 Hex : 5.41	R282 235 011 (M22520/5-11)
R161 184 000	2.5	10	22.5	20	R282 231 000 Hex : 10.54	R282 235 116 (Y116 Daniels)
R161 184 036		16.7	29.2	26.7		
R161 186 000		10	22.5	20		
R161 186 137	5	8	21	16		

1

- Slide onto the cable the ferrule.
- Strip the cable.

3

- Crimp the ferrule with crimping tool.
- Solder inner conductor.

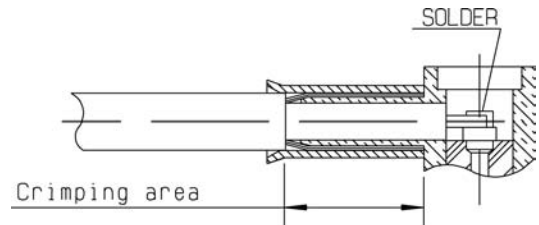

2

- Fan the braid.
- Push connector body under the braid.
- Slide the ferrule on the braid (in direction F).

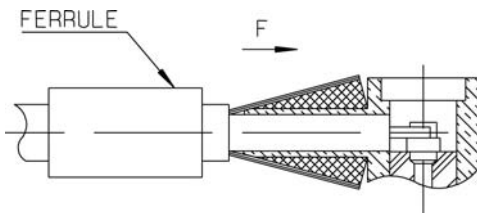

4

- Screw the nut into the body or press cap flush or slightly below surface of body assembly.

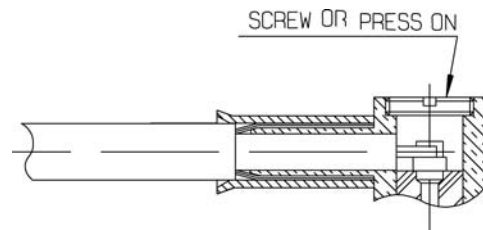

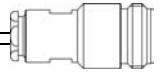

M 09

STRIPPING DIMENSIONS

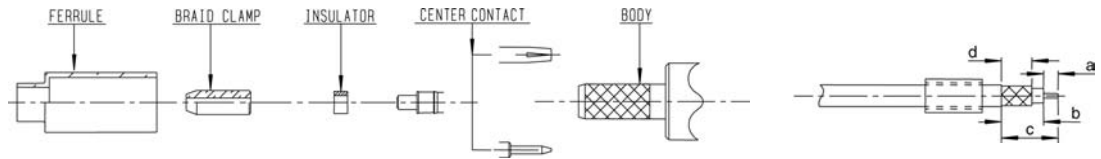

Part number	Stripping length (mm)				Dies included	Crimping tool	
	a	b	c	d		MIL standard R282 293 000 (M22520/5-01) + Dies	Center contact
R161 072 000 R161 311 200 R161 311 300	4.5	9.5	14	8	R282 223 000 Hex : 5.41	R282 235 011 (M22520/5-11)	R282 223 000 Hex : 1.73

- 1**

 - Slide the ferrule onto the cable.
 - Strip the cable.

3

 - Slide cable dielectric into the body while gently grinding the braid over the knurl.
 - Push until the dielectric clicks into position.
 - Slide ferrule over the braid (in direction F).

- 2**
- Fan the braid.
 - Slide the braid clamp and insulator between the dielectric and the braid.
 - Slide on center contact until it bottoms against cable dielectric.
 - Crimp center contact with crimping tool or solder.

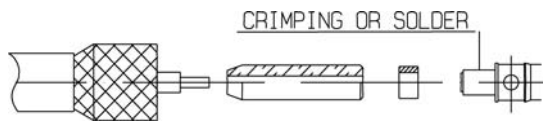

- 4**
- Crimp the ferrule with crimping tool.
 - Cut the excess of braid.

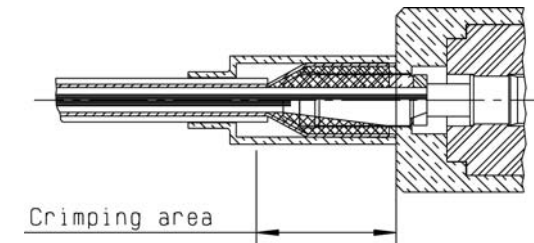

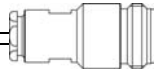

M 10

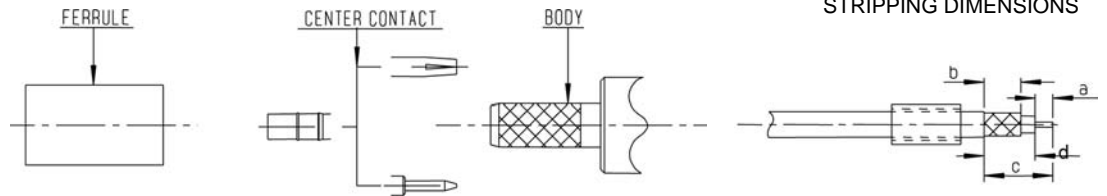

Part number	Stripping length (mm)				Crimping tool	
	a	b	c	d	Dies included	MIL standard R282 293 000 (M22520/5-01) + Dies
R161 075 000 R161 243 000 R161 088 000 R161 286 000 R161 241 000 R161 286 200	5	8	14	9	R282 231 000 Hex: 2.54 - 10.54	R282 235 116 Y116 Daniels
R161 075 060 R161 076 000		9	15	10		

- 1**

 - Slide the ferrule onto the cable.
 - Strip the cable.

3

 - Fan the braid.
 - Slide cable dielectric into the body while gently ginding the braid over the knurl.
 - Push until the dielectric clicks into position.
 - Slide ferrule over the braid (in direction F).

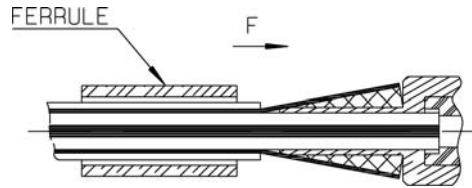

- 2**
- Slide on center contact until it bottoms against cable dielectric.
 - Crimp center contact with crimping tool.

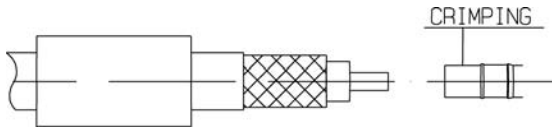

- 4**
- Crimp the ferrule with crimping tool.
 - Cut the excess of braid.

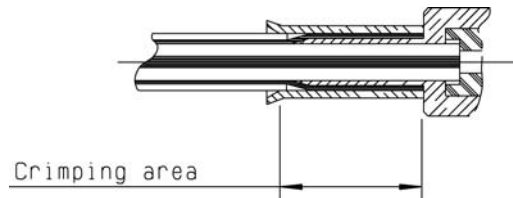

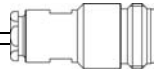

M 11

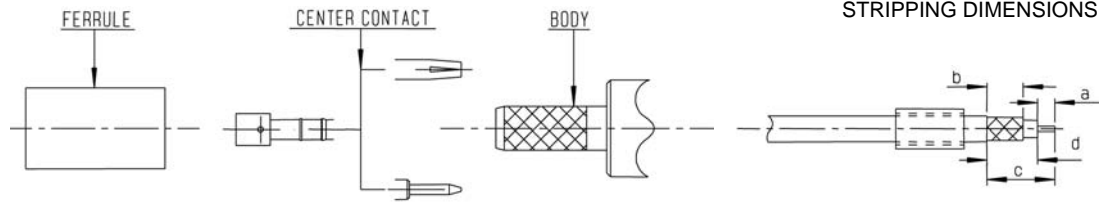

Part number	Stripping length (mm)				Hex.	Crimping tool	
	a	b	c	d		Dies included	MIL standard R282 293 000 (M22520/5-01) + Dies
R161 083 137	4.5	8	14	9.5	ferrule 5.41 center contact 1.73	R282 223 000	R282 235 011 (M22520/5-11)
R161 088 137	5			9	10.5	ferrule 10.54 center contact 2.54	R282 231 000
R161 185 000 R161 187 000	4.5		15				

1

- Slide onto the cable the ferrule.
- Strip the cable.

3

- Fan the braid.
- Slide cable dielectric into the body while gently ginding the braid over the knurl.
- Push until the dielectric clicks into position.
- Slide ferrule over the braid (in direction F).

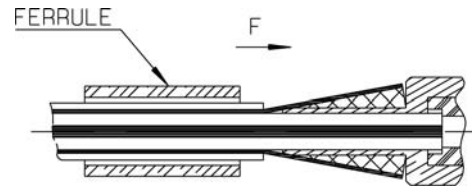

2

- Slide on the center contact until it bottoms against cable dielectric.
- Crimp center contact with crimping tool.

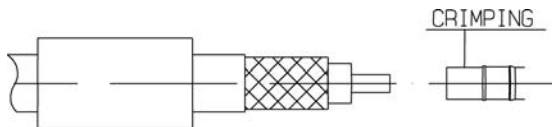

4

- Crimp the ferrule with crimping tool.
- Cut the excess of braid.

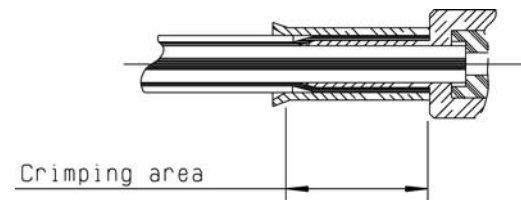

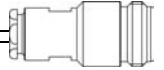

M 12

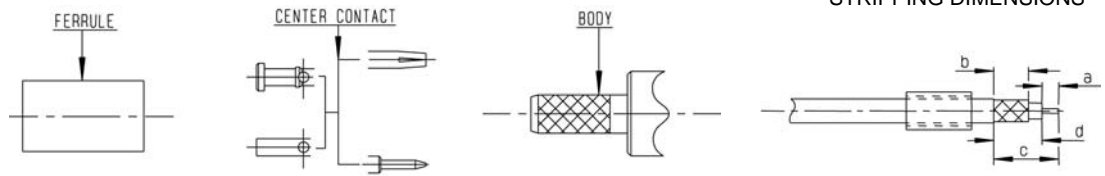

Part number	Stripping length (mm)				Hex.	Center contact crimping tool		Ferrule crimping tool	
	a	b	c	d		Dies included	MIL standard R282 293 000 (M22520/5-01) + dies	Dies included	MIL standard R282 293 000 (M22520/5-01) + dies
R162 084 000 R162 184 000	4.5	8	14	9.5	1.73-6.48	R282 223 000	R282 235 011 (M22520/5-11)	R282 223 000	R282 235 013 (M22520/5-13)
R162 239 000		7.5	15.5	11					
R162 335 000		8	16	11.5					
R162 075 000	5	8	14	9	1.73-10.54	R282 223 000	R282 235 011 (M22520/5-11)	R282 231 000	R282 235 116 (Y116 DANIELS)
R162 088 000	7.5	17	12.5						
R162 185 000	8	15	10.5						
R162 187 000 R162 241 000 R162 243 000	7.5	17	12.5						
R162 336 000 R162 339 000	4.5	8	16	11.5					
R161 082 000 R161 083 000 R161 237 000 R161 238 000 R161 283 000 R161 329 000 R161 329 200	4.5	8	14	9.5	1.73-5.41	R282 223 000	R282 235 011 (M22520/5-11)		

1

- Slide the ferrule onto the cable.
- Strip the cable.

2

- Slide center contact on until it bottoms against cable dielectric.
- Crimp the center contact.

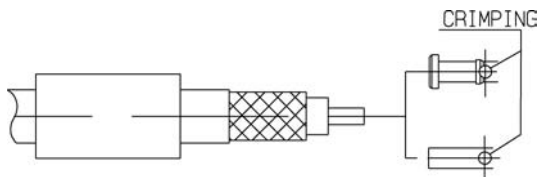

3

- Fan the braid.
- Slide the cable into the body until it bottoms against insulator.
- Slide the ferrule over the braid (in direction F).

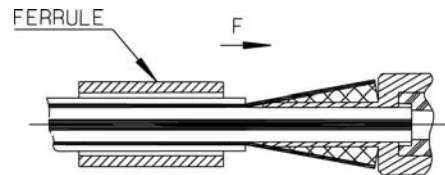

4

- Crimp the ferrule.
- Cut the excess of braid if necessary.

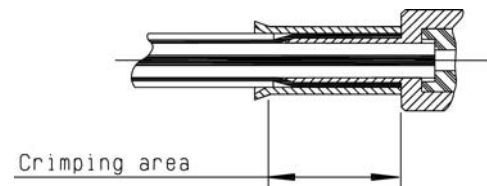

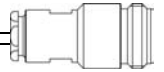

M 13

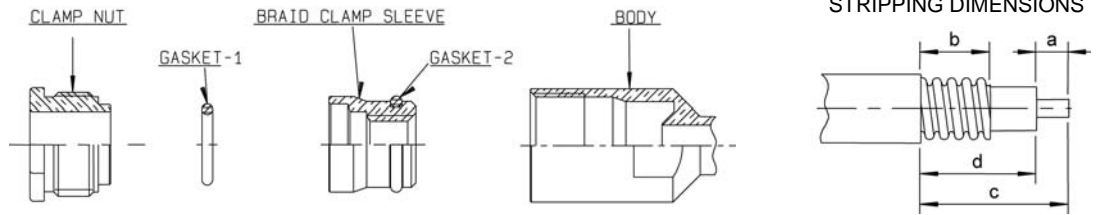

Part number	Stripping tool	Stripping length (mm)					
		a	b	c	d	e	f
R161 177 007	R282 010 030	7.5	10	22.5	15	16	
R161 177 207	R282 010 040	9	12	29	20	21	20
R161 177 137	R282 010 050	10.5	14	33.5	23		

- 1**
- Strip the cable.
 - Strip the cable inner conductor with stripping tool.

- 2**
- Slide the clamp nut and the gasket-1 onto the cable.
 - Screw the clamp braid sleeve with the gasket-2 on to the spiral braid of the cable.
 - Tighten manually.

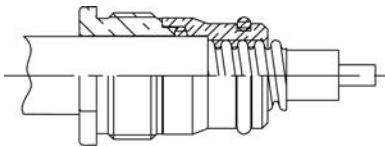

- 3**
- Screw the clamp nut into the connector body. (recommended coupling torque 70.8 in.lb - 800 Ncm). (The cable must not turn into the right angle body).
 - Solder the cable inner conductor into center contact.

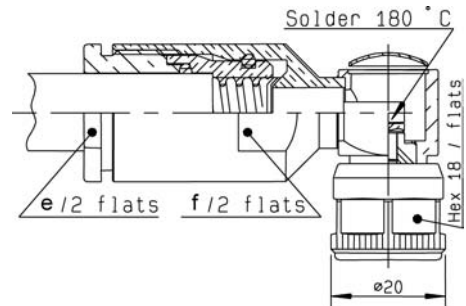

- 4**
- Place the cap.
 - Press fit the cap with a flat punch.

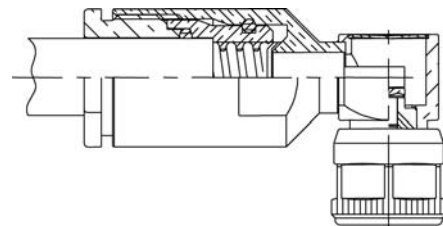

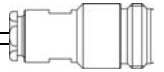

M 14

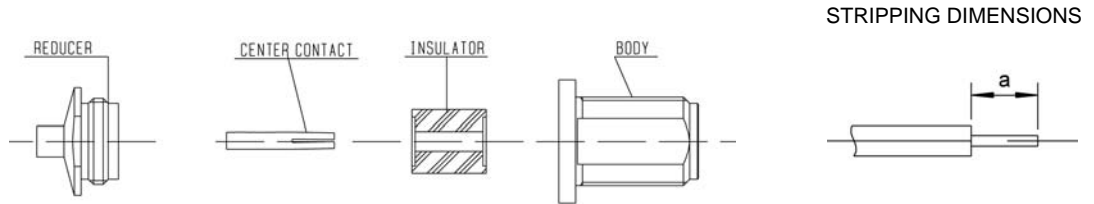

Part number	Stripping length (mm) a	Stripping tool	Trimmer	Solder gauge [thickness b]	Positioner
R161 335 200	3.17	R282 051 000	R282 063 000	R282 862 090 [0.7]	R282 744 300
R161 226 020 R161 277 300 R161 336 000 R161 336 200	4.5	R282 053 000	R282 066 010		R282 744 310
R161 337 200			R282 054 000	R282 074 020	R282 862 080 [0.45]

- 1**
- Take the tool kit : R282 125 010.
 - Strip the dielectric of the cable with stripping tool.
 - Trim the cable center conductor with trimmer.
 - Clean the cable.
 - Screw the reducer on the cable.

- 2**
- Screw the positioner R282 744 060 onto the soldering jig R282 740 030.
 - Slide contact into positioner.
 - Insert solder gauge between contact and cable.
 - Tighten and solder the contact.

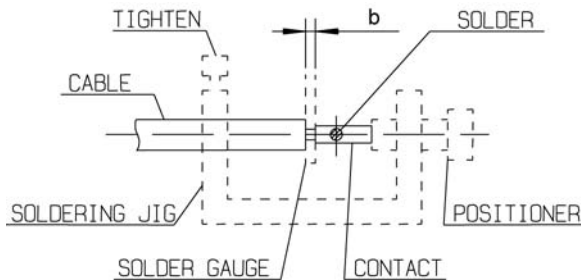

- 3**
- After cooling remove cable assembly from the jig.
 - Put positioner on the soldering jig.
 - Slide cable into the reducer until it bottoms against positioner.
 - Tighten.
 - Put 3 rings of solder around the cable and solder.

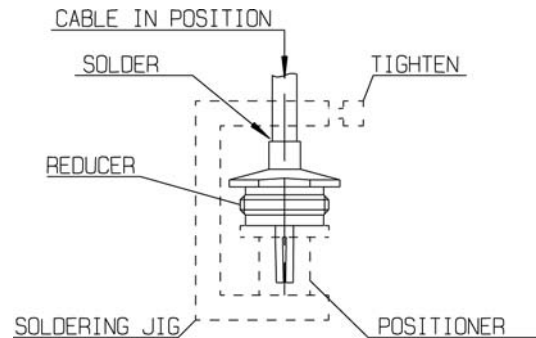

- 4**
- After cooling remove cable assembly from the jig.
 - Slide insulator into the center contact.
 - Screw sub-assembly into the connector body. (recommended coupling torque 13.27 in.lb - 150 Ncm).

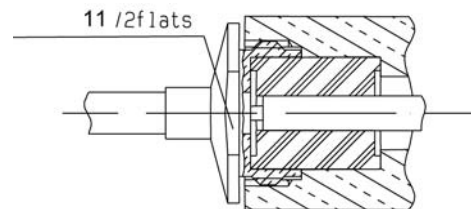

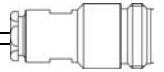

M 15

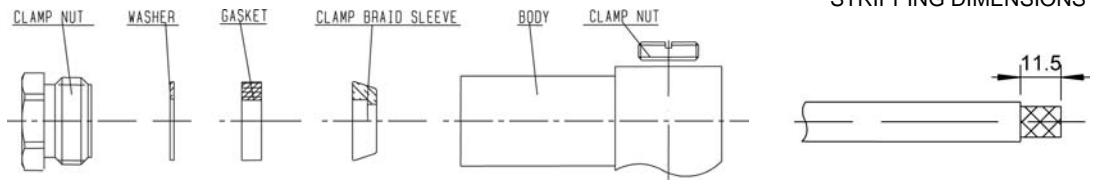

Part number
R161 157 000

- 1**
- Strip the cable.

- 2**
- Slide the clamp nut, the washer and the gasket onto the cable.
 - Slide clamp braid sleeve over braid.
 - Fold back braid and trim off excess of braid.
 - Trim back dielectric as shown.

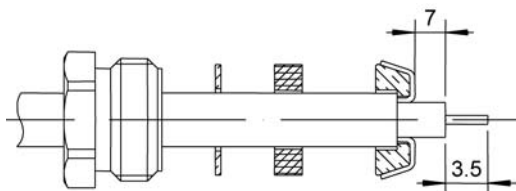

- 3**
- Screw sub-assembly into the connector body. (recommended coupling torque 13.27 in.lb - 150 Ncm).
 - Solder center contact.

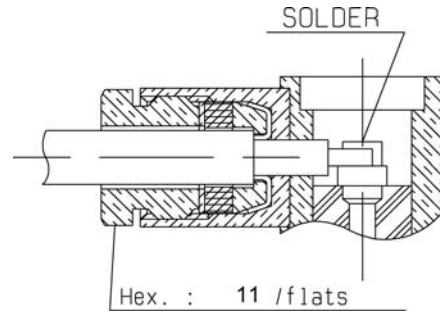

- 4**
- Screw clamp nut into the body.

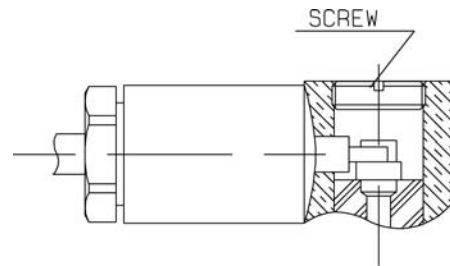

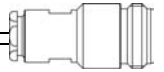

M 16

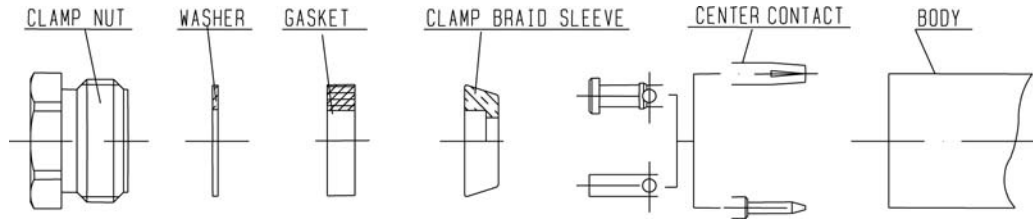

Part number	Stripping length (mm)			Center contact crimping tool	
	a	b	c	Dies included	MIL standard R282 293 000 (M22520/5-01) + dies
R161 168 000	10	4	2.5	R282 231 000 Hex. 2.54	R282 235 116 (Y116 DANIELS)
R162 013 000 R162 213 000		4.5	1.5		
R162 162 000 R162 168 000	8.5	4	1		

1

- Strip the cable.



2

- Slide the clamp nut, the washer and the gasket onto the cable.
- Slide clamp braid sleeve over braid.
- Fold back braid and trim off excess of braid.
- Trim back dielectric as shown.

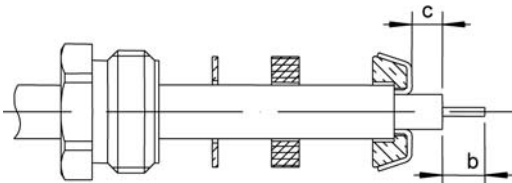

3

- Solder the cable inner conductor into center contact.

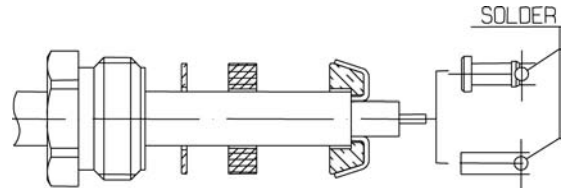

4

- Screw sub-assembly into the connector body. (recommended coupling torque 44.25 in.lb - 500 Ncm).

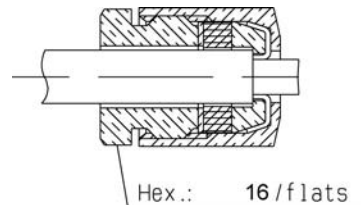

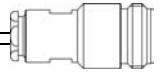

M 17

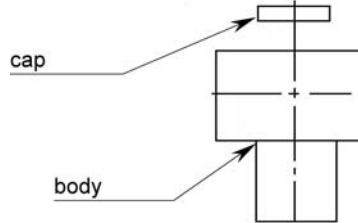

STRIPPING DIMENSIONS

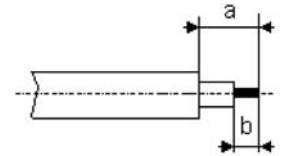

We recommend a thermal preconditioning cable

Part number	Stripping length (mm)		Soldering Assembly
	a	b	
R161 152 107	9	3	R282 740 030

- 1**
- Strip the dielectric of the cable .
 - Clean the cable.
 - Temperature stoking do not exceed 250° max.

- 2**
- Slide cable and connector onto the soldering jig.
 - Slide cable into connector until it bottoms against the body and tighten.
 - Solder the body onto the cable.

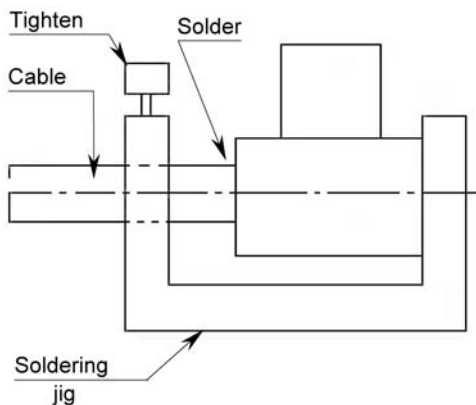

- 3**
- After cooling remove cable assembly from the jig.
 - Slide body into positioner until it bottoms against the positioner.
 - Slide cable assembly onto the jig.
 - Tighten and solder the contact.
 - After cooling remove cable assembly from the jig.

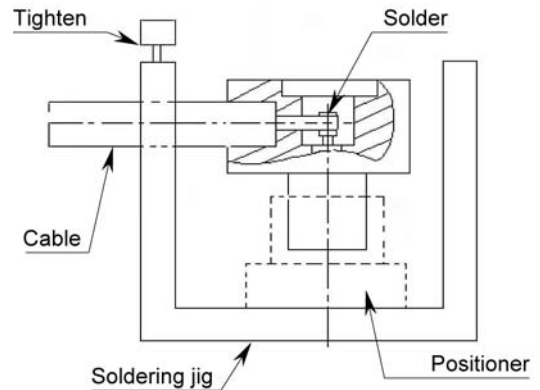

- 4**
- Screw the cap until it bottoms against the body (direction F).

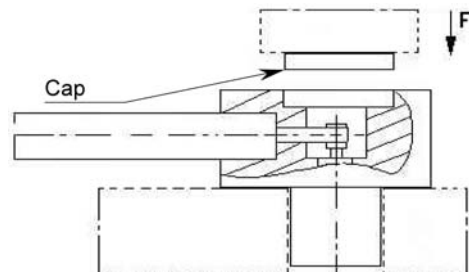

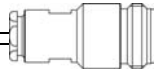

M 18

STRIPPING DIMENSIONS

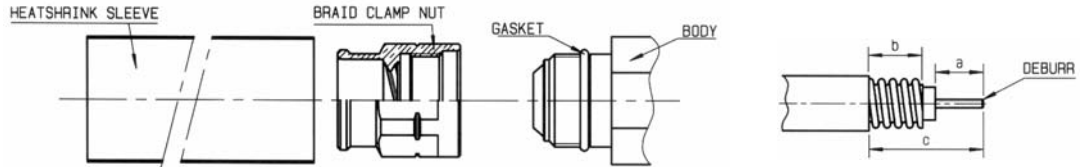

Part number	Stripping length (mm)			Stripping tool	Torque spanner
	a	b	c		
R161 036 007 R161 232 007 R161 279 007 R161 341 007	5.5	5	11.5	R282 010 030	R282 303 220 (0.708 in 84.075 in lb)
R161 036 207 R161 232 207 R161 279 207 R161 341 207				R282 010 040	
R161 037 020 R161 232 407 R161 279 407 R161 341 407				R282 010 050	

1

- Strip the cable.
- Do not damage the outer conductor.
- Deburr cable inner conductor.

3

- Screw the connector onto the assembly.
WARNING : Screw the connector on the braid clamp nut turning left (left-hand thread) so that the copper outer conductor is being squeezed.

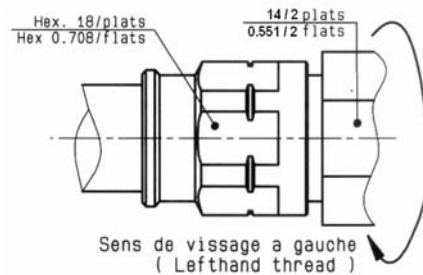

2

- Slide the heatshrink sleeve onto the cable.
- Screw manually the braid clamp nut onto cable outer conductor until stop.

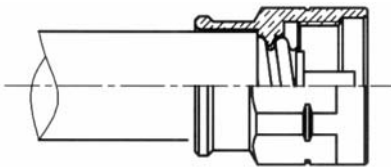

4

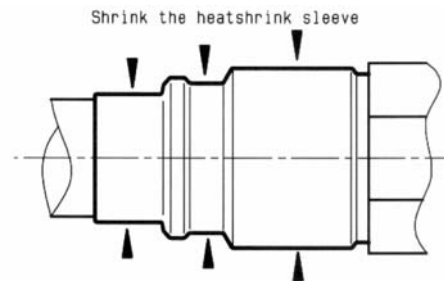

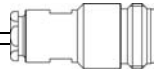

M 19



STRIPPING DIMENSIONS

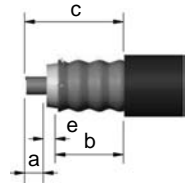

Part number	Stripping length (mm)				Stripping tool
	a	b	c	e	
R161 091 020 W	5	16	23.7	2.7	R282 011 050

1

- Cut the cable end in a hollow (between two rings) with a hacksaw.
- Raise the handle and introduce the cable until it stops in the stripping tool.
- Push down the handle by exerting a light pressure on it, keep turning the tool until it turns freely.
- Hold the handle down, and turn the tool (of approximately ¼ of tour) in the opposite direction, while pulling gently on the cable in order to release pieces of the cable cut.
- Raise the handle, slide the cable out and remove loose pieces of cable.
- In case of cut parts jammed in the tool : raise the handle, introduce again the stripped cable in the tool, screw slightly the cable into the copper previously cut and remove cable + loose parts.
- Push down again the handle.

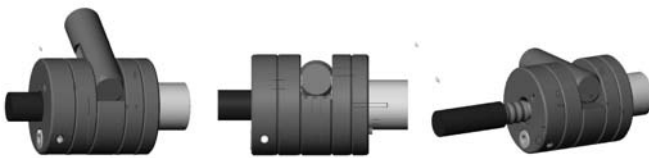

2

- Introduce the cable in the opposite side of the tool.
- Turn the tool and exert a light pressure until stop.
- After cutting the dielectric cut will be extracted on the other side of the tool.



3

- Introduce the cable in the tool as shown.
- Turn the tool to point the inner conductor of the cable.



4

- Mount the clamp nut on the cable, until the clipsage of the elastic contact on the first annelure.
- To push the part defers the tow press in stop on the elastic contact.

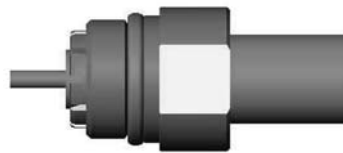

5

- Mount the clamp nut with the cable in the body of the connector.
- Couple of tightening recommended: 800 Ncm

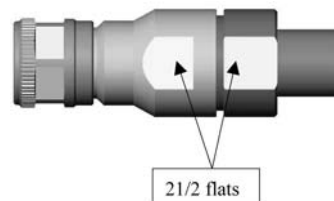

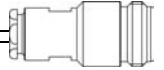

M 20

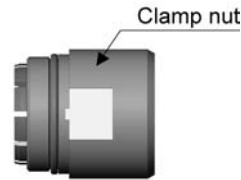
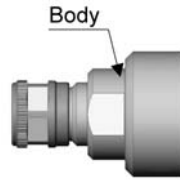

STRIPPING DIMENSIONS



Part number	Stripping length (mm) a	Stripping tool for cable 7/8 corrugated
R161 033 020W	26	R282 011 060

1

- Cut the front extremity of the cable on the summit of a ring with a hacksaw ("a" dimension).
- Raise the handle and push the cable stops until it.
- Lowered the handle using a light pressure on it.
- Hold the handle down, and turn the tool (of approximately 1/4 of tour) in the opposite direction, while pulling gently on the cable in order to release pieces of the cable cut.
- Raise the handle, slide the cable out and remove loose pieces of cable.
- Split the sheath with a cutter, perpendicular to the previously split.
- Remove the sheath.



2

- Slide the clamp device over the cable, until the elastic part snap into the first groove of the outer conductor.
- Push forward the nut of the clamp device until it stops against the elastic part.



3

- Screw the connector on the nut of the clamp device.
- Recommended mating torque: 2500 Ncm

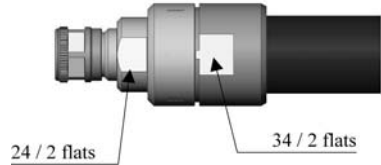

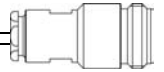

M 21



STRIPPING DIMENSIONS

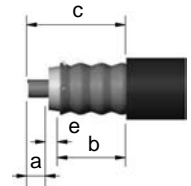

Part number	Stripping length (mm)				Stripping tool
	a	b	c	e	
R161 230 320W	5	16	23.7	2.7	R282 011 050

1

- Cut the cable end in a hollow (between two rings) with a hacksaw.
- Raise the handle and introduce the cable until it stops in the stripping tool.
- Push down the handle by exerting a light pressure on it, keep turning the tool until it turns freely.
- Hold the handle down, and turn the tool (of approximately 1/4 of tour) in the opposite direction, while pulling gently on the cable in order to release pieces of the cable cut.
- Raise the handle, slide the cable out and remove loose pieces of cable.
- In case of cut parts jammed in the tool: raise the handle, introduce again the stripped cable in the tool, screw slightly the cable into the copper previously cut and remove cable + loose parts.
- Push down again the handle.

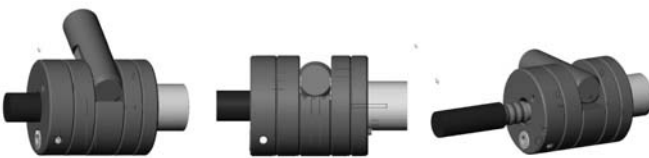

2

- Introduce the cable in the opposite side of the tool.
- Turn the tool and exert a light pressure until stop.
- After cutting the dielectric cut will be extracted on the other side of the tool.



3

- Introduce the cable in the tool as shown.
- Turn the tool to point the inner conductor of the cable.



4

- Mount the clamp nut on the cable, until the clipsage of the elastic contact on the first annelure.
- To push the part defers the tow press in stop on the elastic contact.

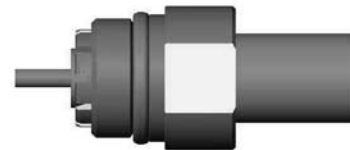

5

- Mount the clamp nut with the cable in the body of the connector.
- Couple of tightening recommended: 800 Ncm.

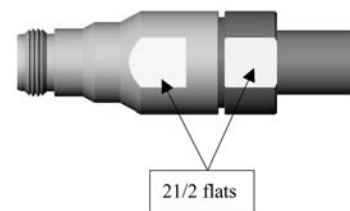

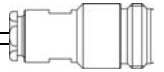

M 22

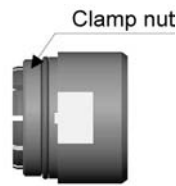
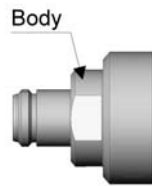

STRIPPING DIMENSIONS



Part number	Stripping length (mm) a	Stripping tool
R161 231 020W	26	R282 011 060

1

- Cut the front extremity of the cable on the summit of a ring with a hacksaw (a dimension).
- Raise the handle and push the cable stops until it.
- Lowered the handle using a light pressure on it.
- Hold the handle down, and turn the tool (of approximately 1/4 of tour) in the opposite direction, while pulling gently on the cable in order to release pieces of the cable cut.
- Raise the handle, slide the cable out and remove loose pieces of cable.
- To split the sheath with a tool cutting perpendiculary to the previously undertaken split.
- To remove the sheath cut.



2

- Slide the clamp device over the cable, until the elastic part snap into the first groove of the outer conductor.
- Push forward the nut of the clamp device until it stops against the elastic part.



3

- Screw the connector on the nut of the clamp device.
- Recommended mating torque: 2500 Ncm.

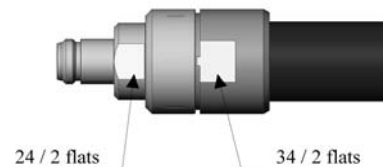

NOTES
